

FRIENDSHIP

102" Wide-Body
DIESEL

BY GULF STREAM®

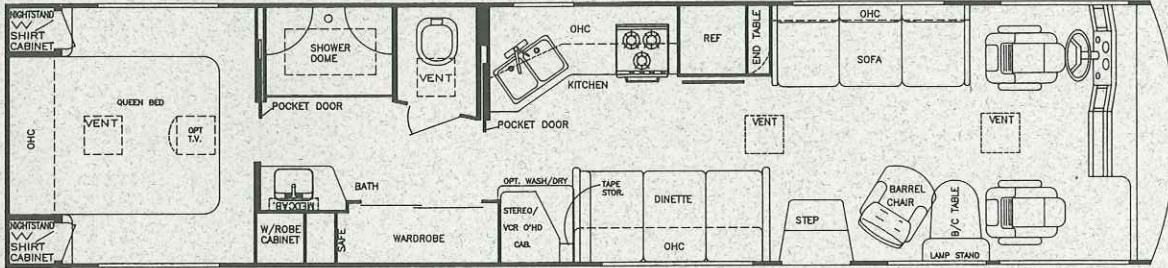

Model 8390 (Side Door Entry)

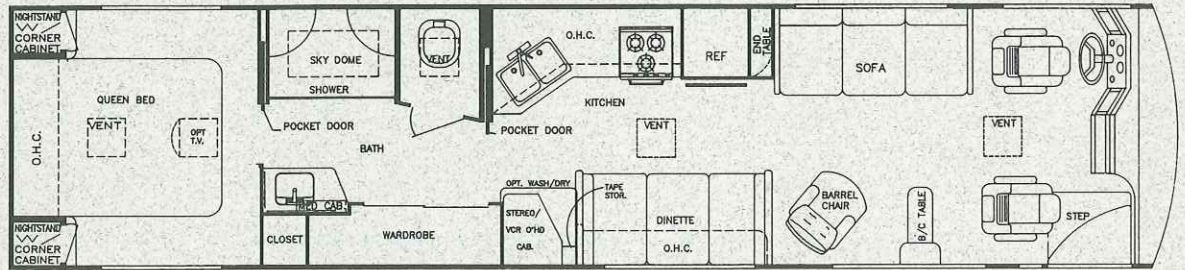

Model 8390 (Front Door Entry)

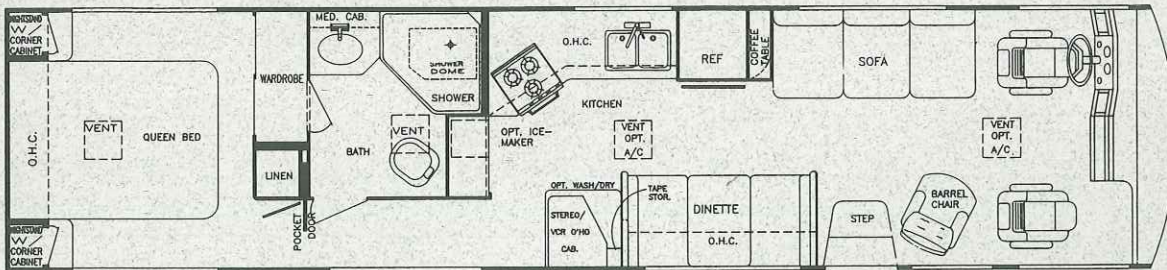

Model 8391 (Side Door Entry)

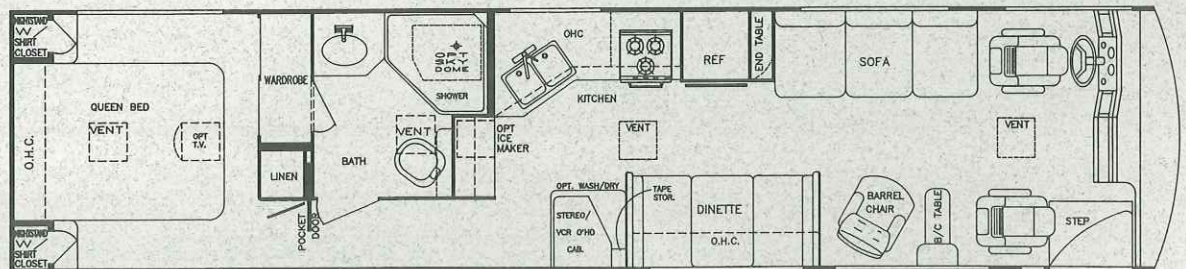

Model 8391 (Front Door Entry)

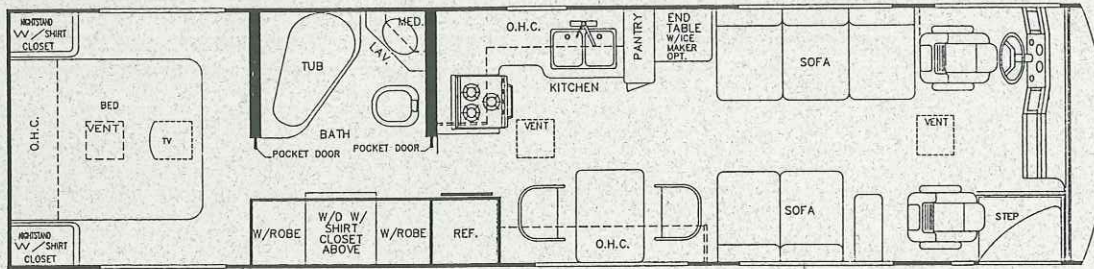
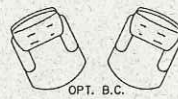

Model 8360

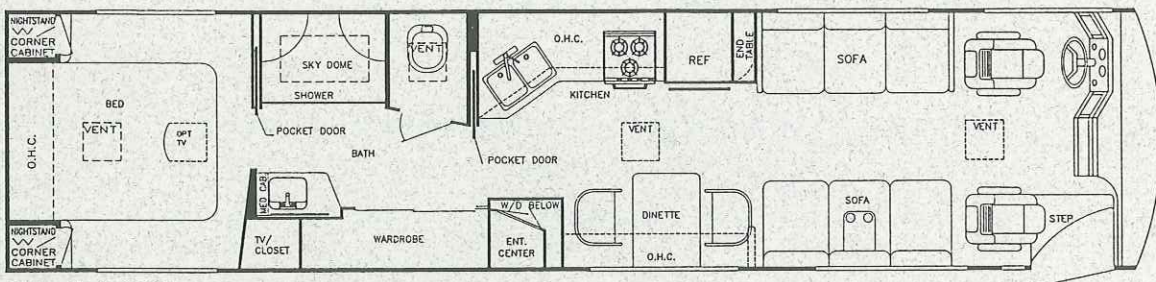

Model 8392

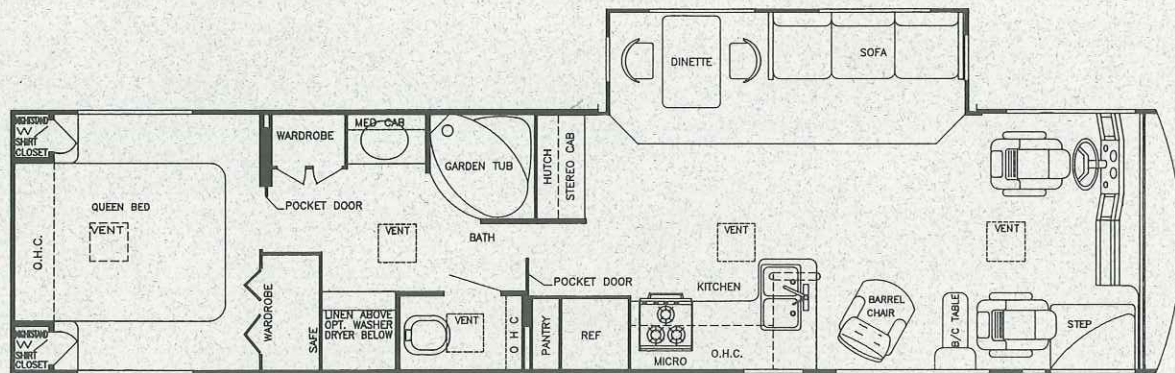

Model 8393 (Glide-Out Expando)

FRIENDSHIP

BY GULF STREAM®

102" Wide-Body DIESEL

Standard Specifications

Interior and Decor

- Hawaiian KOA Laminated Cabinetry
- Woodland Rose Interior (Optional)
- Laminated Formica Paneling
- Radius Cabinet & Wall Corners
- Fabric-Covered Shelving
- Solid Surface Countertops
- Custom Padded Dash w/Illuminated Gauges
- Deluxe Furniture
- 3-Way Driver & Passenger Seats with Leather Seating Surface
- Deluxe Carpet w/Pad
- Tile Floor in Kitchen
- Day/Night Shades Throughout
- Deluxe Privacy Drapes
- Coordinated Bedspreads & Shams
- Cedar-Lined Wardrobe
- Beveled Glass Decorator Mirrors in Living Area, Bedroom & Bathroom
- Carpeted Ceiling
- "Villa" Leather Driver & Buddy Seat w/Power Foot Rest (Optional)

Exterior and Construction

- 1-1/2" x 1-1/2" Tubular Steel Cage Construction
- Laminated Floors w/Metal Underbelly
- Super-Structure Steel Floor System
- Laminated 2" Thick Floor, Wall & Roof Construction
- R-7.5, 1 1/2" Block Foam Insulation in Floor, Walls & Roof
- Sidewalls Lag-Bolted Every 8" or Less to Floor Structure
- Full Fiberglass Front and Rear Caps
- Fiberglass Integrated Bumpers
- Exterior Entertainment Center (Opt.)
- Fully-Welded Steel Firewall
- Sealed Perimeter & Engine Compartment
- Seamless, One-Piece Radiused Rubber Roof
- Roof Lag-Bolted Every 8" or Less to Sidewalls
- Super-Slick Laminated Fiberglass Siding
- Tinted Windshield & Windows
- Color-Coordinated Paint Scheme w/Contemporary Painted Graphics & Clear Coat Finish
- Outstanding Side-to-Side, Carpeted, Lighted Exterior Storage
- Back-Up Alarm
- Convenient Rally Hook-Up System

Electrical System

- Slide-Out Coach Batteries
- 12-Volt, 75-Amp Converter w/Battery Charger
- Electrical Supply Cord -- 50 Amp (30 Amp Cord on CSA)
- Electric Overload Protection
- Automotive-Type Color-Coded Wiring
- AM/FM Stereo Cassette in Dash
- Lighted Entry Way and Aisle Lights
- Directional Reading and Map Lights
- Positive Battery Shut-Off Switches
- Electric Step
- 7.5 Onan Diesel Generator (opt.) on Automatic Front Slide-Out Tray
- Optional Deluxe Rack-Mounted Stereo System with CD Player

Bath and Water

- Dual Holding Tanks -- Approx. 54 Gal. Each
- Fresh Water Tank -- Approx. 77 Gal.
- Super Flow Manifold Water Distribution System (N/A w/CSA)
- Demand Water System
- City Water Hook-Up
- Double-Bowl Stainless Steel Sink
- Sink Covers
- Shower w/Gold-Tone Shower Stall and Fixtures
- Gravity Drains on Fresh Water Lines
- 10 Gal. Gas/Electric Water Heater

Appliances

- 3-Burner High-Output Range Top
- Lighted Power Range Hood
- Large, 2-Way, Flush-Mounted Double-Door Refrigerator
- Side-by-Side, Double-Door 3-Way Refrigerator (Opt.)
- Microwave/Convection Oven
- Residential Telephone
- 19" Color TV w/VR

Heating, Ventilation and Air Conditioning

- 40,000 BTU Furnace w/Residential Duct System
- Two 13,500 BTU Ceiling Ducted Air Conditioners
- 15,000 BTU Front Air Conditioner (Opt.)

Spartan Diesel Chassis

- Channel-Type, 8" x 3 1/2" x 1/4", Raised-Rail Frame
- Stemco Seals -- Bearings Lubricated w/Oil Instead of Grease
- 14-Gauge Ultra-High Temperature Wire w/Circuit Description Every 3"
- 4-Point V-Pad Engine Mount Greatly Reduces Vibration
- Side-Mounted Rochester Fuel Gauge
- Grau-Midland Anti-Lock Brake System
- Air Brakes w/Midland Pure Air Plus Heated Air Dryer
- Self-Leveling Air Suspension
- Cummins 6 CTA 8.3 Diesel Engine w/ 250 HP, 660 Ft./Lb. Torque, and Roll-Out Feature
- Turbo Charged and After Cooled
- Allison MD 3060P 6-Speed Electronically Shifted Automatic Transmission
- Tilt and Telescoping Douglas Steering Column
- High Capacity Automotive Heater
- Wheel Base: 252" (234" on 8360)
- Approx. Exterior Length : 39' (36' on 8360)
- Exterior Width -- 102"
- Interior Height -- 6' 8"
- Coach Body Height -- 12' Approx.(w/AC)
- Fuel Tank Approx. 100 Gal.

Deluxe Standard Features

- Auto Dash Air Conditioner
- Auto Cruise Control
- Power Vent in Bath
- Auxiliary Batteries
- 115 Lb. LP Tank
- LPG Leak Detector

Your Dealer



GULF STREAM COACH, INC.
P.O. BOX 1005, NAPPANEE, IN 46550

For further information and available floorplan options, contact your nearest dealer or Gulf Stream Coach, Inc. Gulf Stream Coach, Inc. reserves the right to make changes in prices, colors, materials, components and specifications and to discontinue models at any time without notice or obligation. Some items shown may be optional and are not included in the purchase price of the vehicle. Test drive and review a current model on your Gulf Stream dealer's lot today. 10M TP 3/95