

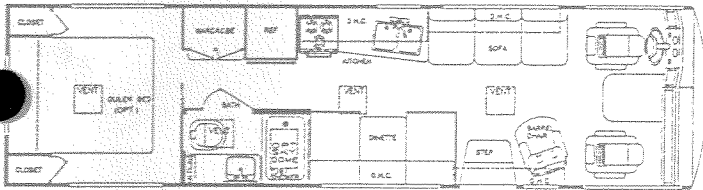

# Sun Voyager

**GAS**  
by Gulf Stream

1994



MODEL 8314

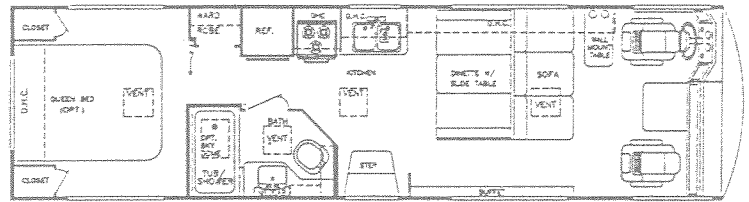

MODEL 8326 (102" Wide)

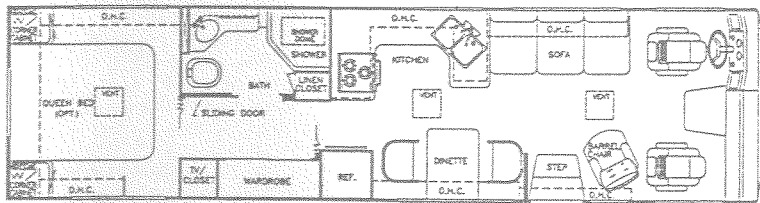

MODEL 8349 (102" Wide)

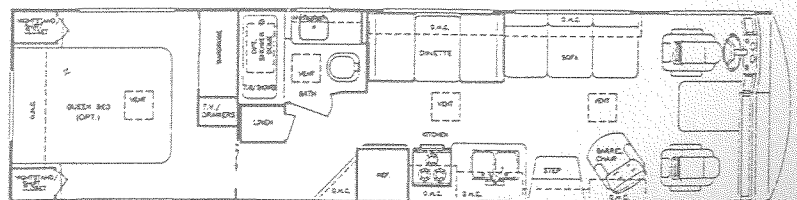

MODEL 8352 (102" Wide)

# Sun Voyager

## Standard Specifications

### Interior and Decor

- High Pressure Laminate Countertops w/Oak Edge
- Custom Padded Dash w/Illuminated Gauges
- Windshield Privacy Drape
- Deluxe Carpet w/Pad
- Deluxe Furniture
- 3-Way Driver Seat
- Coordinated Bedspreads & Shams
- Oak-Framed Decorator Mirror
- Generous Overhead Storage

### Exterior and Construction

- Heated & Fully Enclosed Holding Tanks
- Super Structure Steel Truss Floor System
- Tubular Steel Cage Construction (18 Gauge, 1-1/2" x 1-1/2")
- Laminated Floors w/Metal Underbelly
- 1-1/2" Block Foam Insulation in Floor and Walls
- Fully-Welded Steel Firewall
- Sealed Perimeter & Engine Compartment
- Laminated Fiberglass Exterior
- Panoramic Windshield
- Tinted Windshield & Windows
- Outstanding Exterior Storage
- Deluxe Outside Mirrors
- Radius Rubber Roof w/"Soft Touch" Carpeted Ceiling

### Chassis

- GM 454 CID V-8 Engine w/4-Speed Automatic Transmission, 14,800 GVWR or 16,000 GVWR
- Super-Duty FORD 17,000 lb. GVWR Chassis w/460 CID V-8 & 4-Speed Auto. Trans.
- Electronic Ignition
- Gasoline Tank: Approx. 60-85 Gal. (GM) Approx. 75 Gal. (FORD)
- 4.56:1 Rear Axle Ratio (GM)
- 5.13:1 Rear Axle Ratio (FORD)
- Power Steering
- Wheel Base:
  - Models 8314, 8326 - 190"
  - Models 8349, 8352 - 208"
- Exterior Length:
  - Model 8314 - Approx. 31'
  - Model 8326 - Approx. 32'
  - Model 8349 - Approx. 34'
  - Model 8352 - Approx. 34'
- Interior Height: 6' - 8"
- Exterior Height (No-Air): 10' - 5"

### Bath and Water

- Dual Holding Tanks - Approx. 100 Gal.
- Fresh Water Tank - Approx. 50 Gal.
- Demand Water System
- City Water Hook-Up
- Double Stainless Steel Sink Tub/Shower Combination
- Stand-Up Shower (Model 8349 only)
- Marine Toilet
- Gravity Drains on Fresh Water Lines

### Electrical Systems

- Easy-Access Dual Battery System
- 12-Volt, 45-Amp Converter w/Batt. Charger
- Electric Supply Cord
- Electric Overload Protection
- Generator Compartment
- Automotive-Type, Color-Coded Wiring
- Quad Headlight System

### Appliances

- 3-Burner High-Performance Range w/Oven
- Lighted, Power Range Hood
- 2-Door, 2-Way Refrigerator
- Microwave Ready

### Heating, Ventilation & Air Cond.

- 30,000 BTU Ducted Furnace w/Elec. Ign.
- 40,000 BTU Ducted Furnace w/Elec. Ign. (Models 8326, 8349, 8352)
- Pre-Wired for Roof Air Conditioner
- Ducted Roof Air in 102" Wide-Body Units

### Deluxe Standard Features

- Auto Dash Air Conditioner
- Auto Cruise Control
- Wheel Covers
- Power Vent in Bathroom
- 85 Lb. LP Tank
- AM/FM Cassette w/4 Speakers
- Monitor Panel
- Spare Tire

For further information and available floorplan options, contact your nearest dealer or Gulf Stream Coach, Inc. Also ask about our other Class A motorhomes, Class C motorhomes, Travel Trailers and Fifth Wheels. Gulf Stream Coach, Inc. reserves the right to make changes in prices, colors, materials, components and specifications and to discontinue models at any time without notice or obligation. Gulf Stream Coach, Inc. assumes no responsibility for any error in type or print reproduction of specifications or floorplans in this brochure. TP 20M 2/94



**Gulf Stream Coach, Inc.**

P.O. Box 1005 • Nappanee, IN • 46550

Your Dealer