

SCENIC CRUISER

BY GULF STREAM®

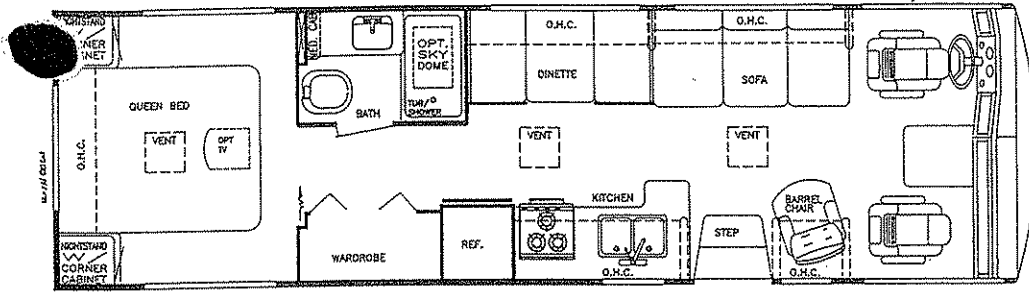

MODEL 8317 GAS

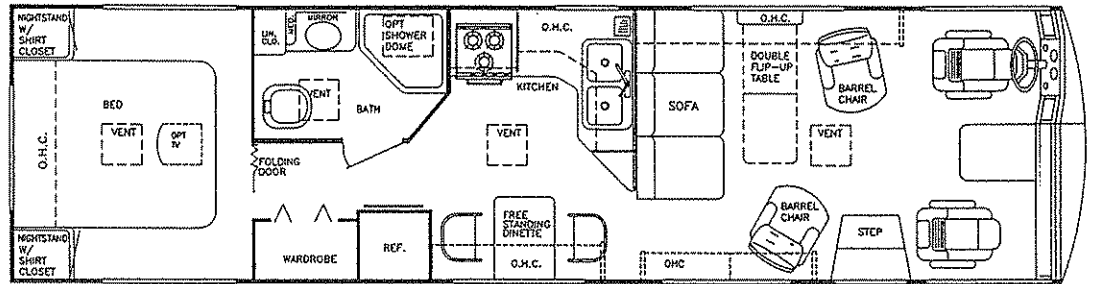

MODEL 8340 GAS

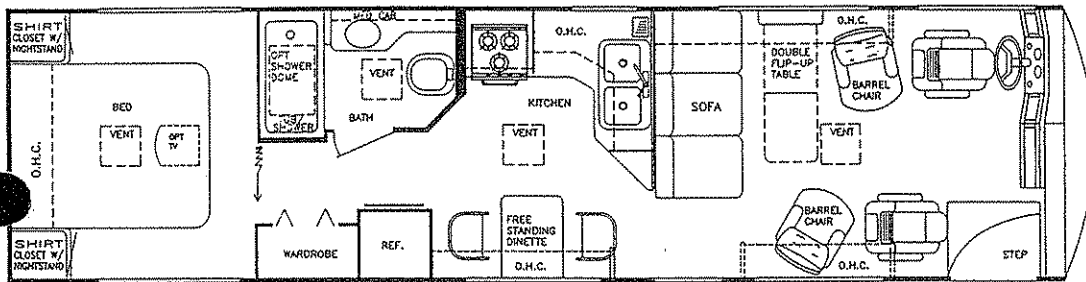

MODEL 8340 DIESEL

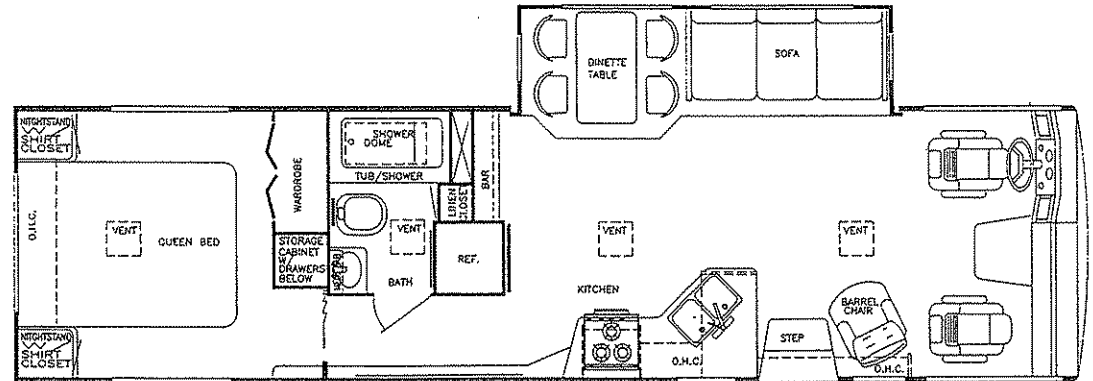

MODEL 8341 GAS

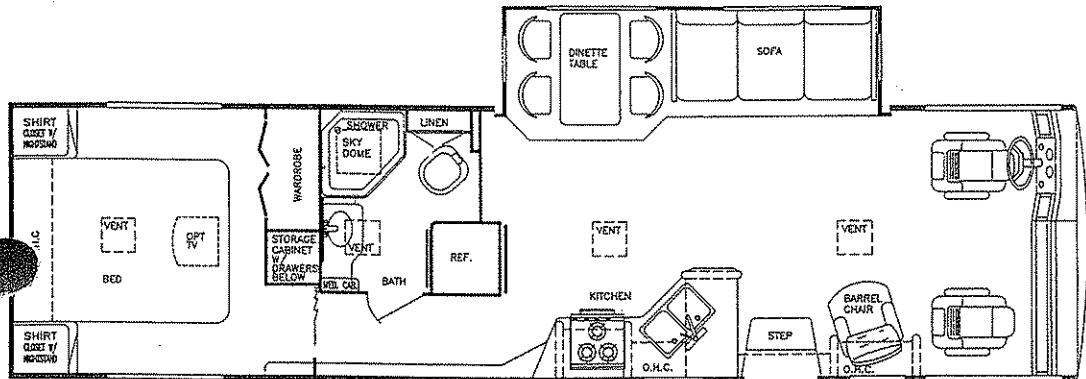

MODEL 8341 DIESEL

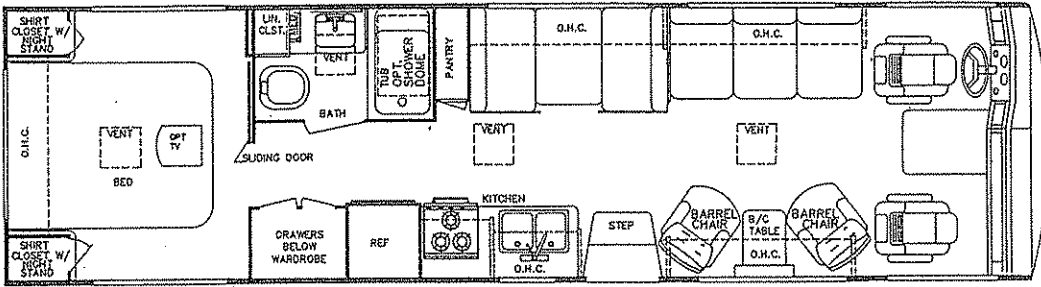

MODEL: 8344 GAS

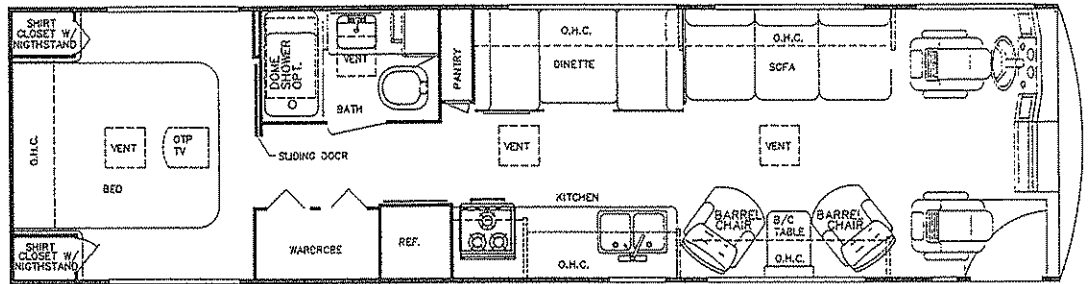

MODEL 8344 DIESEL

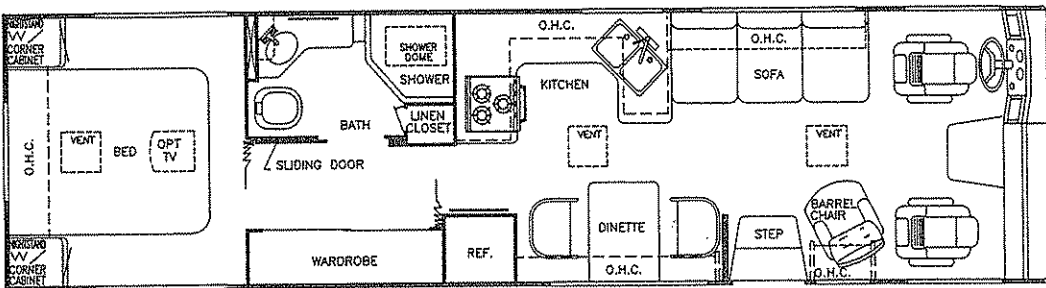

MODEL 8349 GAS

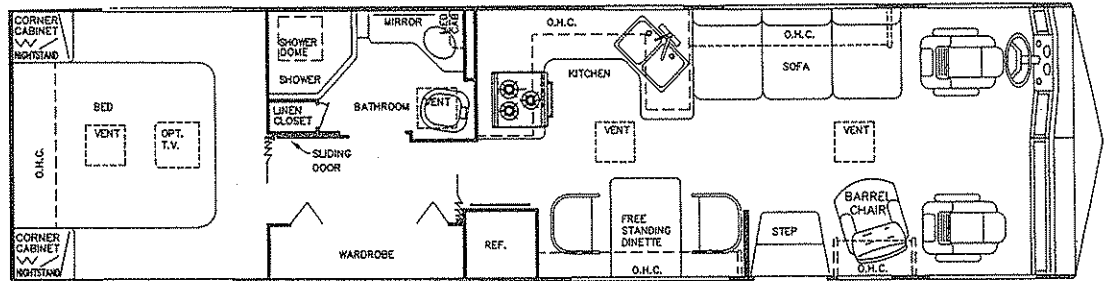

MODEL 8349 DIESEL

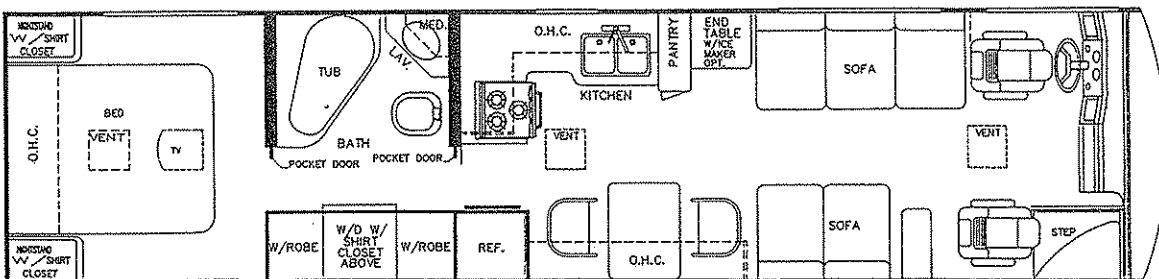

MODEL 8360 DIESEL



SCENIC CRUISER

BY GULF STREAM®

Standard Specifications

Interior and Decor

- Mirage Ivory or Oak Cabinetry w/ Etched-Glass Doors in Living Room & Bedroom
- Granite Solid Surface Kitchen Countertop w/ Backsplash and Knife Holder
- Custom Padded Dash w/ Illuminated Gauges
- Day/Night Pleated Shades in LVRM & BDRM
- Pleated Privacy Curtain
- 3-Way, Feather-Touch Captains Chairs
- Scenic Cruiser Deluxe Accessory Package
- Deluxe Furniture Package
- Deluxe Door & Window Drapes
- Coordinated Bedspread & Shams
- Generous Overhead Storage
- Free Standing Dinette & 2 Chairs (Most Models)
- Queen Size Bed w/ Deluxe Innerspring Mattress
- Mini-Blinds in Kitchen
- Mirrored Closet Doors
- Solar Battery Charger
- Heavy-Duty Clear Vinyl Runner over Carpet

Exterior and Construction

- Heated and Fully Enclosed Holding Tanks
- Rear Fiberglass Cap & Integrated Bumper
- Tubular Welded Steel Construction (Sidewalls and Roof)- (Aluminum on 34' Gas models)
- Tubular Steel Floor Construction
- Standing Side-to-Side, Carpeted and Lighted Exterior Storage
- Laminated Floors w/ Metal Underbelly
- 2" Block Foam Insulation in Floor, Walls and Roof
- Radius Entry Door w/ Deadbolt Lock
- Sealed Perimeter & Engine Compartment
- Laminated Fiberglass Exterior w/ Integrated Fiberglass Skirts & Compartment Doors
- Panoramic Windshield
- Tinted Windshield & Windows
- Deluxe Outside Mirrors
- Radius Rubber Roof w/ "Soft Touch" Carpeted Ceiling
- Pass-Through Storage Doors
- U.V. Protective Privacy Curtain
- Jalousie Windows in Bedrooms
- Hide-A-Bed Sofa in Slide-Outs

Bath and Water

- Dual Holding Tanks - Approx. 90 Gal.
- Fresh Water Tank - Approx. 60 Gal.
- Super-Flow Manifold Water Distribution System
- Demand Water System
- City Water Hook-Up
- Double Stainless Steel Sink
- White Single Lever Kitchen Faucet
- Gold Neo-Angle Shower Surround
- Brass-Look Bath Fixtures
- Deluxe Dual Pedestal Marine Toilet w/ Sprayer
- Gravity Drains on Fresh Water Lines
- Sky Dome in Shower Area
- Light Switch in Bath Room
- 6 Gal. D.S.I. Water Heater
- One-Piece Tub Surround
- 10 Gal. DSI Water Heater (36' only)

Appliances

- Deluxe 3-Burner Range w/ Oven
- Lighted, Power Range Hood
- 2-Door, 2-Way Refrigerator
- TV Antenna w/ Amp, Booster and 2 Jacks
- 19" Color TV (VCR Ready)
- LP Gas Leak Detector
- Carbon Monoxide Detector

Electrical Systems

- Easy Access Dual Battery System
- Electric Supply Cord
- Electric Overload Protection
- Automotive-Type, Color-Coded Wiring
- Power Vent in Bath & Kitchen

Heating, Ventilation & Air Conditioning

- 40,000 BTU Ducted Furnace w/ Electronic Ignition
- Prepped for Ceiling-Ducted Air Conditioning

Chassis

- Spartan EC 2000, Raised Rail Chassis w/ Cummins 6BT 5.9, 190 HP @ 2500 RPM, 475 ft. lb. Torque @ 1700 RPM, Turbo-Charged Rear Mounted Diesel Engine Standard
- Allison AT 542 4-Speed Transmission Standard
- 230HP @ 2500 RPM, 605 ft. lb. Torque @ 1700 RPM, Turbo-Charged Rear Mounted Diesel Engine (w/ Allison 6-Speed World Trans., and Air-Ride Suspension) OPTIONAL
- Model 8341 Only: Super Duty FORD Chassis w/ 460 CID V-8 & 4-Speed Automatic Transmission (Diesel available)
- 4.63:1 Rear Axle Ratio (Spartan)
- 5.13:1 Rear Axle Ratio (Super Duty FORD)
- Power Steering w/ Front and Rear Disc Brakes
- Fuel Tank: Approx. 80 Gal. - Spartan
Approx. 75 Gal. - Super Duty FORD
- Wheel Base: Spartan -
Model 8360 - 234"
Models 8340, 8341, 8344, 8349 - 208"
Gas - Models 8317 & 8341 - 178" + Tag,
Model 8349 - 208"
- Exterior Length: Model 8317 - Approx. 31',
Model 8360 - 36'
All Others - Approx. 34'
- High Capacity Automotive Heater
- Tilt Steering Wheel
- Interior Height: Approx. 6' - 8"
- Exterior Height: Approx. 11' - 11" (w/ A.C.)

Deluxe Standard Features

- Electric Step
- Safe-T-Plus Steering System (Diesel Only)
- Stainless Steel Wheel Inserts
- Rally Hook-Up
- Rear Ladder
- Floor Mats
- Super Slick Fiberglass Exterior
- Auto Dash Air Conditioner
- Auto Cruise Control
- AM/FM Cassette w/ 4 Speakers
- Monitor Panel in Range Hood
- 85 lb. LP Tank - Gas Engine
- 115 lb. LP Tank - Diesel Engine
- Radial Tires
- Driving Lights
- Towing Hitch
- Floor Safe
- Lighted Entry Step



GULF STREAM COACH, INC.
P.O. BOX 1005 • Nappanee, Indiana 46550

For further information and available floorplan options, contact your nearest dealer or Gulf Stream Coach, Inc. Gulf Stream Coach, Inc. reserves the right to make changes in prices, colors, materials, components and specifications and to discontinue models at any time without notice or obligation. Gulf Stream Coach, Inc. assumes no responsibility for any error in type or print reproduction of specifications or floorplans in this brochure. U.S. Patent Pending

10M TP 3/95

IF YOU WANT A COACH THAT'S BUILT AS WELL AS A GULF STREAM...

1. Seamless Rubber Roof For Greater Energy Efficiency and Dependability.

2. Luan Decking for Additional Strength.

3. Molded E.P.S. Brick Insulation Provides Consistent Insulative Value As Well As Superior Dimensional Rigidity.

4. One-Piece Formed Aluminum Air Conditioning Duct, Completely Surrounded By Polystyrene Insulation.

5. Bubble-Wrapped Foil Insulation Provides Superior Insulation.

6. Rugged Welded Steel Tube Roof Framing.

7. Soft Touch Ceiling Fabric for Added Sound Insulation.

8. Aluminum Cove Molding.

9. Bubble-Wrapped Foil Insulation Minimizes Thermal Transfer.

10. Rugged Roll-Formed Steel Roof-to-Sidewall Transition Member Insures Structural Integrity and Stability.

11. Die-Stamped Steel Transition Member Gusseting Provides Greater Strength and Structural Integrity.

12. Rugged Heavy-Gauge Steel Tubing, Fixture Welded to Form the Sidewall Framing.

13. High-Density E.P.S. Insulation Provides Superior Laminating and Bonding Characteristics and Insures Greater Energy Efficiency.

14. Interior Wall Panels Securely Laminated to Steel Framed Sidewall.

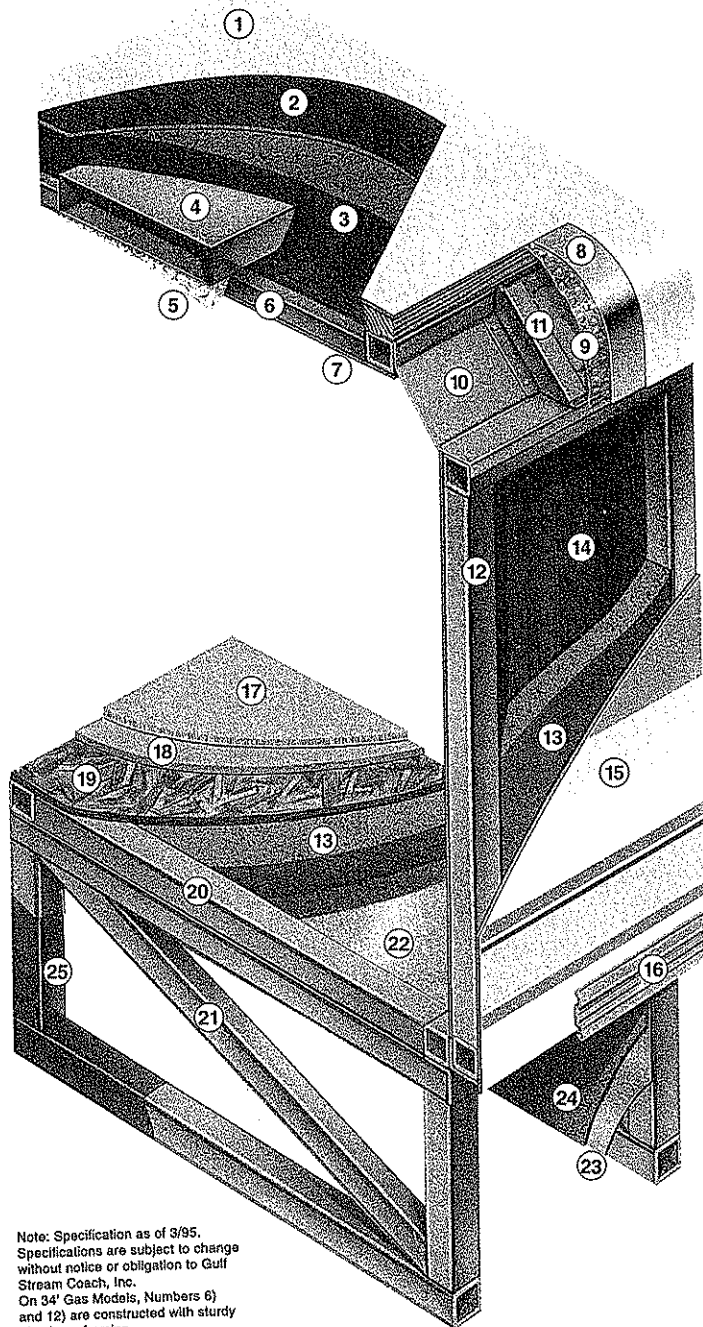

Note: Specification as of 3/95. Specifications are subject to change without notice or obligation to Gulf Stream Coach, Inc. On 34' Gas Models, Numbers 6) and 12) are constructed with sturdy aluminum framing.



15. "Fiberspan" Fiberglass Exterior Body Surface Vacuum Laminated to Steel Sidewall Framing for Lasting Beauty and Durability.

16. Aluminum Trunk Door Hinge Extrusion Provides A Tight Seal Discouraging Air or Water Infiltration.

17. High-Quality Stain-Resistant Carpeting Available in Designer-Coordinated Colors.

18. Extra-Thick Padding Under Carpet Provides Extra Comfort and Increases Carpet Durability.

19. Continuous Structurewood Floor Decking Laminated to Steel Floor Structure Assures a Quiet, Long-Lasting, Rigid Floor

20. Heavy-Gauge Steel Tube Framing, Fixture Welded for Extra Strength and Stability.

21. Heavy-Gauge Steel Tube Framing, Fixture Welded Floor Truss System Provides the Strongest Motorhome Foundation in the Industry.

22. Seamless Layer of Galvanized Steel Securely Laminated to the Steel Floor Framing.

23. Galvanized Steel Used to Form Each Storage & Holding Compartment.

24. Durable All-Weather Carpeting Completes Each Accessible Storage Compartment, Providing Extra Protection for Luggage and Valuables.

25. Rust-Prohibitive Paint Coating Applied to All Steel Framing Assures Corrosion and Rust Protection.

IT'S GOING TO HAVE TO BE A GULF STREAM!