

1996

Sun Voyager

BY GULF STREAM®

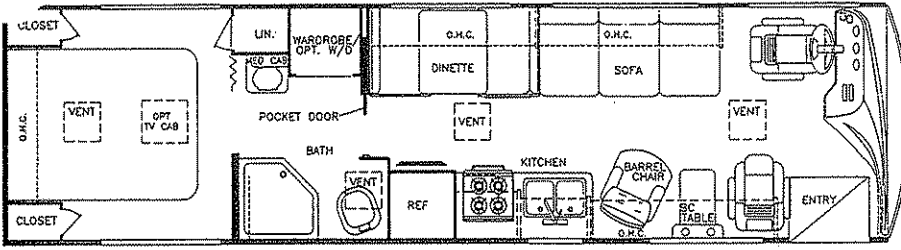

Model 8293 SYD (96" Wide)

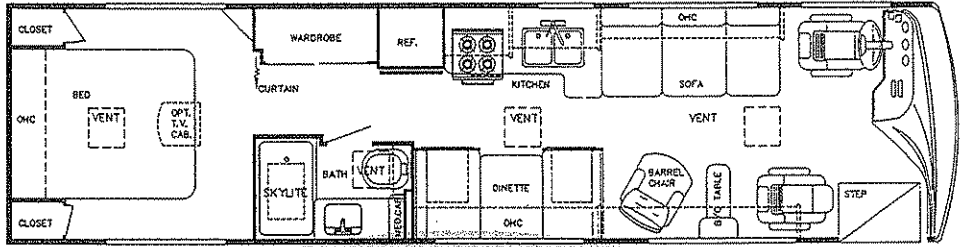

Model 8313 SYD (96" Wide)

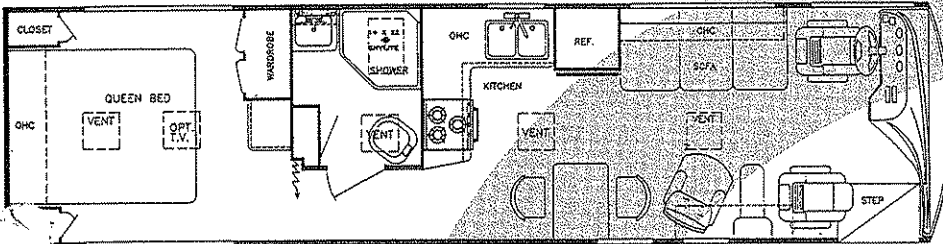

Model 8324 SYD (96" Wide)

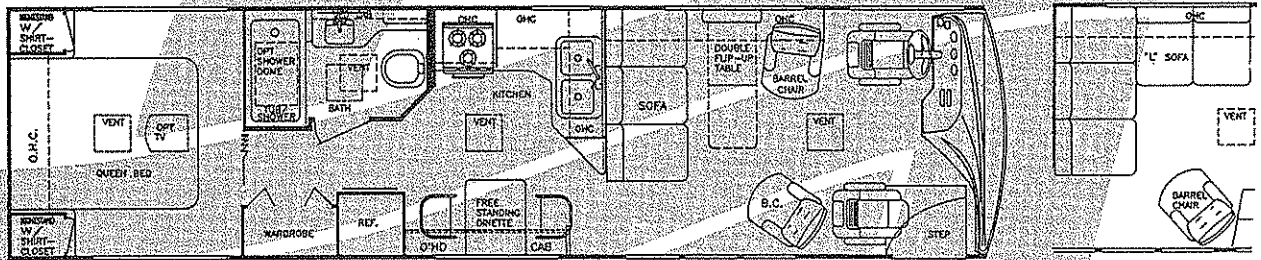

Model 8340 MXD (102" Wide)

Panoramic Windows

Optional L-Sofa

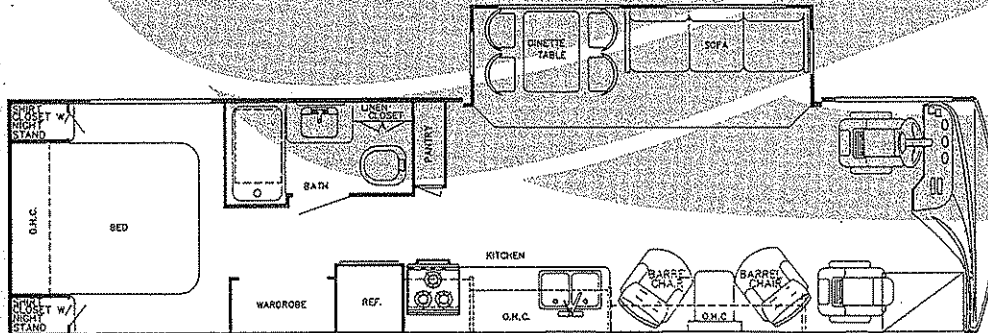

Model 8342 SYD (96" Wide)

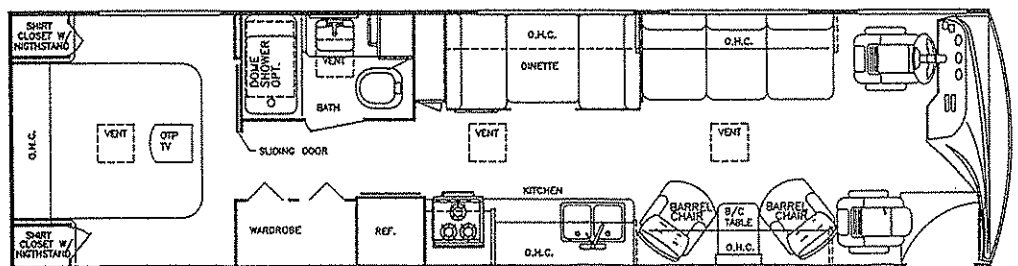

Model 8344 MXD (102" Wide, Sofa available p/o chairs)

Sun Voyager

BY GULF STREAM

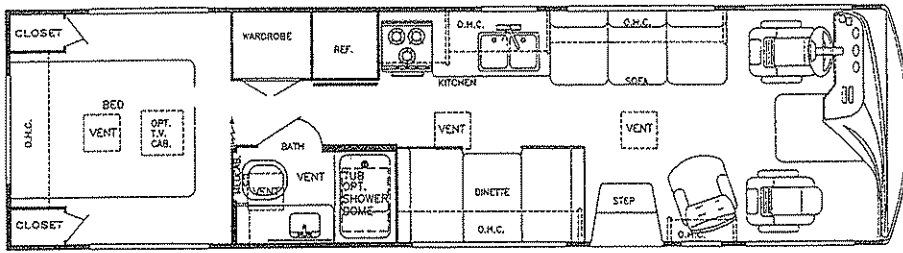

Model 8314 SYG (96" or 102" Wide)

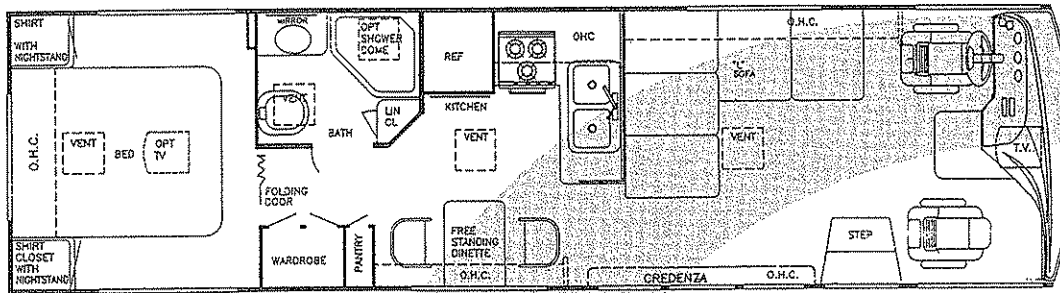

Model 8330 MXG (102" Wide)

Panoramic Windows

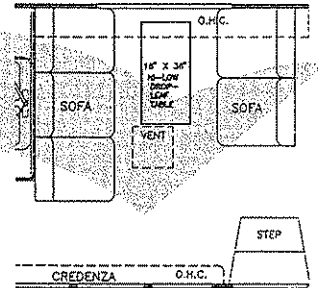

Optional Sofa/So

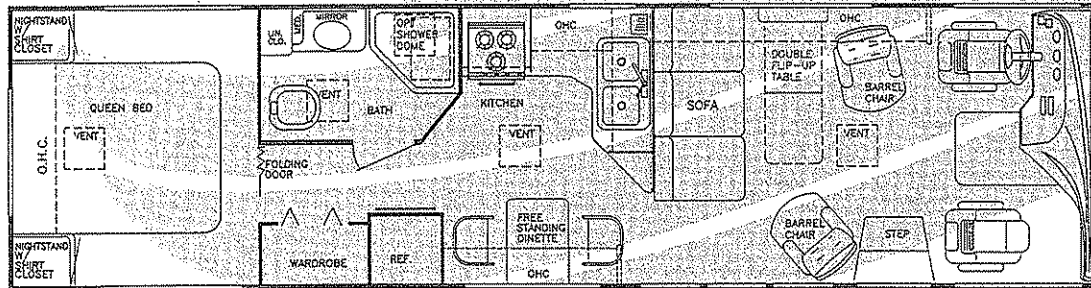

Model 8340 MXG (102" Wide)

Panoramic Windows

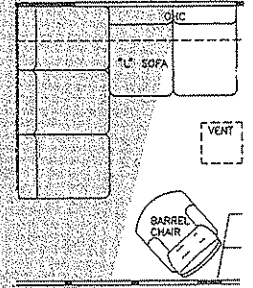

Optional L-Sofa

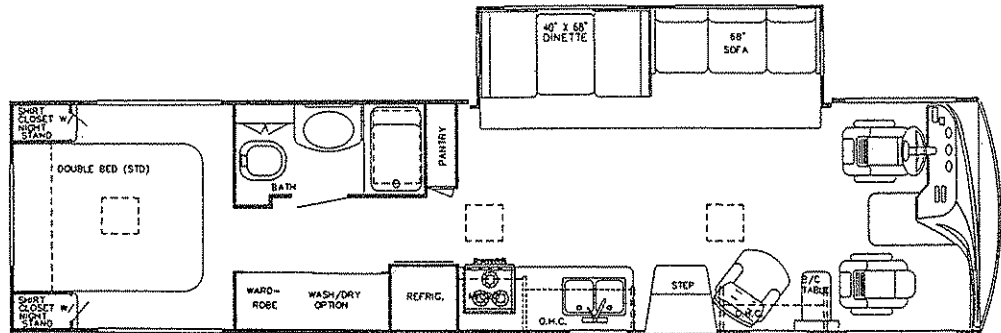

Model 8342 SYG (96" Wide)

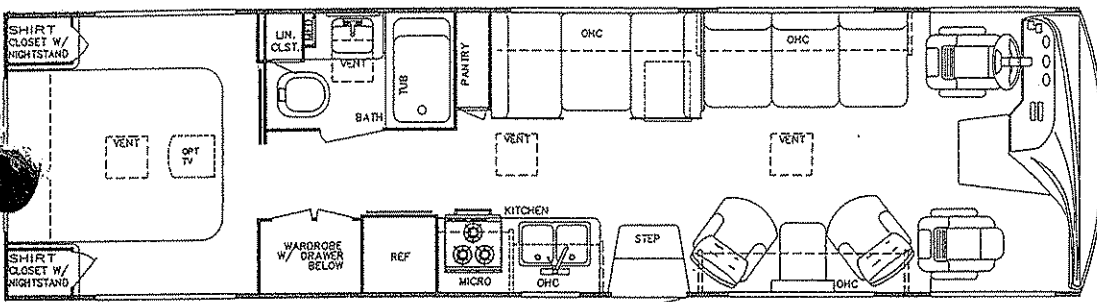

Model 8344 MXG (102" Wide, Sofa available p/o chairs)

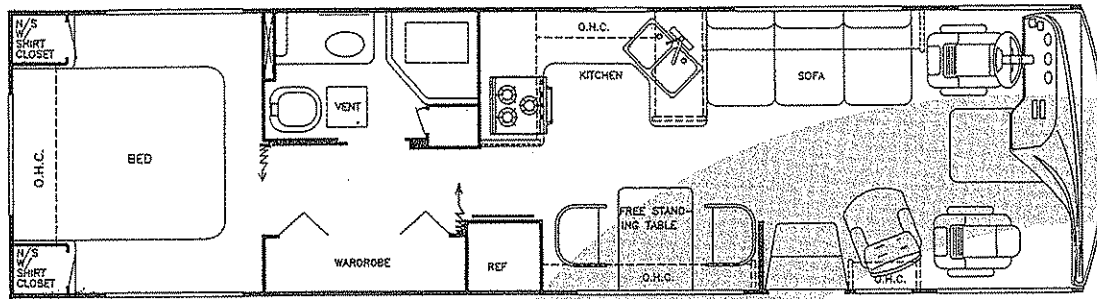

Model 8349 MXG (102" Wide)

Optional Washer/Dryer

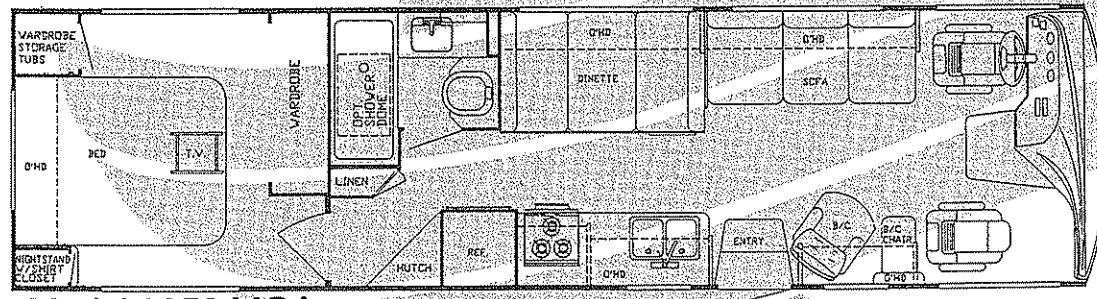

Model 8352 MGA (102" Wide)

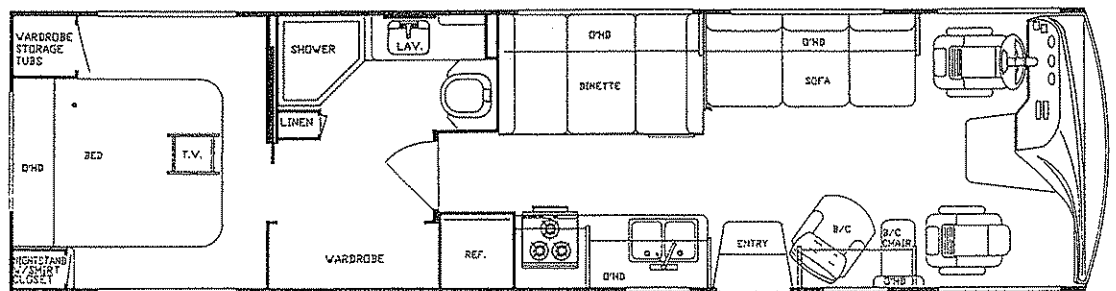

Model 8352 MGB (102" Wide)

IF YOU WANT A COACH THAT'S BUILT AS WELL AS A GULF STREAM...

1. Seamless Rubber Roof For Greater Energy Efficiency and Dependability.

2. Luan Decking for Additional Strength.

3. Molded E.P.S. Brick Insulation Provides Consistent Insulative Value As Well As Superior Dimensional Rigidity.

4. One-Piece Formed Aluminum Air Conditioning Duct, Completely Surrounded By Polystyrene Insulation.

5. Bubble-Wrapped Foil Insulation Provides Superior Insulation.

6. Rugged Welded Tube Roof Framing.

7. Soft Touch Ceiling Fabric for Added Sound Insulation.

8. Aluminum Cove Molding.

9. Bubble-Wrapped Foil Insulation Minimizes Thermal Transfer.

10. Rugged Roll-Formed Steel Roof-to-Sidewall Transition Member Insures Structural Integrity and Stability.

11. Die-Stamped Steel Transition Member Gusseting Provides Greater Strength and Structural Integrity.

12. Rugged Heavy-Gauge Tubing, Fixture Welded to Form the Sidewall Framing.

13. High-Density E.P.S. Insulation Provides Superior Laminating and Bonding Characteristics and Insures Greater Energy Efficiency.

14. Interior Wall Panels Securely Laminated to Steel Framed Sidewall.

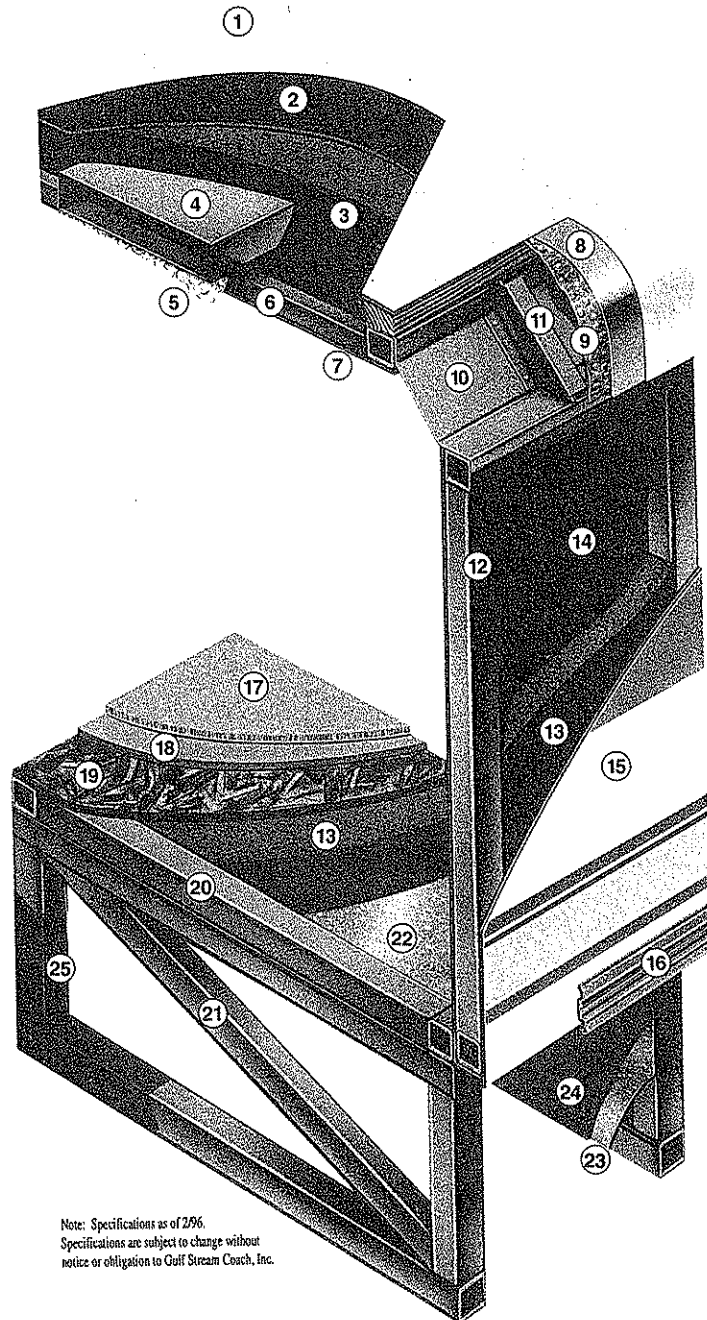

Note: Specifications as of 2/86. Specifications are subject to change without notice or obligation to Gulf Stream Coach, Inc.

15. "Fiberspan" Fiberglass Exterior Body Surface Vacuum Laminated to Steel Sidewall Framing for Lasting Beauty and Durability.

16. Aluminum Trunk Door Hinge Extrusion Provides A Tight Seal Discouraging Air or Water Infiltration.

17. High-Quality Stain-Resistant Carpeting Available in Designer-Coordinated Colors.

18. Extra-Thick Padding Under Carpet Provides Extra Comfort and Increases Carpet Durability.

19. Continuous Structurewood Floor Decking Laminated to Steel Floor Structure Assures a Quiet, Long-Lasting, Rigid Floor

20. Heavy-Gauge Steel Tube Framing, Fixture Welded for Extra Strength and Stability.

21. Heavy-Gauge Steel Tube Framing, Fixture Welded Floor Truss System Provides the Strongest Motorhome Foundation in the Industry.

22. Seamless Layer of Galvanized Steel Securely Laminated to the Steel Floor Framing.

23. Galvanized Steel Used to Form Each Storage & Holding Compartment.

24. Durable All-Weather Carpeting Completes Each Accessible Storage Compartment, Providing Extra Protection for Luggage and Valuables.

25. Rust-Prohibitive Paint Coating Applied to All Steel Framing A Corrosion and Rust Protection.



IT'S GOING TO HAVE TO BE A GULF STREAM!

SPECIFICATIONS

	8330	8340	8342	8344	8349	8352
	460	460	460	460	460	460
	17,000 lb.	17,000 lb.	17,000 lb.	17,000 lb.	17,000 lb.	17,000 lb.
	6,000 lb.	6,000 lb.	6,000 lb.	6,000 lb.	6,000 lb.	6,000 lb.
	11,000 lb.	11,000 lb.	11,000 lb.	11,000 lb.	11,000 lb.	11,000 lb.
	454	454	454	454	454	454
	16,500 lb.	16,500 lb.	16,500 lb.	16,500 lb.	16,500 lb.	16,500 lb.
	5,500 lb.	5,500 lb.	5,500 lb.	5,500 lb.	5,500 lb.	5,500 lb.
	11,000 lb.	11,000 lb.	11,000 lb.	11,000 lb.	11,000 lb.	11,000 lb.
	N/A	210/230	N/A	210/230	N/A	N/A
000	N/A	19,000/23,000	N/A	19,000/23,000	N/A	N/A
00	N/A	7,000/8,000	N/A	7,000/8,000	N/A	N/A
000	N/A	12,000/15,000	N/A	12,000/15,000	N/A	N/A
	208"	208"	208"	208"	208"	208"
	33' - 4"	34' - 4"	34' - 3"	34' - 4"	33' - 8"	34' - 4"
	11' - 7"	11' - 11"	11' - 7"	11' - 11"	11' - 7"	11' - 7"
	101	101	101	101	101	101
	80	80	80	80	80	80
	97	97	97	97	97	97
	70	90	52	90	48	50
	45	45	45	45	45	45
	45	45	45	45	45	45
	6 Gal.	6 Gal.	6 Gal.	6 Gal.	6 Gal.	10 Gal.
	75/60	75/60	75/60	75/60	75/60	75/60
	N/A	80	N/A	80	N/A	N/A

*All Weights And Sizes Are Approximate And Subject To Change Without Notice

Chassis (Gas Models)

- Electronic Ignition
- Power Steering & Brakes
- High-Capacity Auto. Heater
- Tilt Steering Wheel
- Tag Axle System (8341 Gas)

Chassis (Diesel Models)

- Spartan EXP 2001, 19,000 lb. GVWR Chassis w/Cummins 6BT 5.9, 210HP @2500 RPM 520 ft.lb. Torque @1600 RPM Turbo-Charged Rear Mounted Diesel Engine
- Allison AT-542 4-Speed Automatic Transmission
- Air Over Hydraulic 15" Dia. Front & Rear Disc Brakes w/ Air Actuated, Spring-Applied Parking Brake
- Full Air-Ride Suspension
- 230 HP @ 2500 RPM, 605 ft. lb. Torque @ 1700 RPM, Turbo-Charged Rear Mounted Diesel Engine (w/6-Speed Allison World Transmission) Optional

Deluxe Standard Features

- Auto Dash Air Conditioner
- Auto Cruise Control
- Wheel Covers
- AM/FM Cassette w/4 Spkrs.
- Monitor Panel
- Power Vent in Commode
- Converter w/Battery Charger
- Auxiliary Battery
- Generator Ready
- 115 lb. LP Tank (85 lb. on gas models)
- 19" Color TV in Front Overhead
- Carbon Monoxide Detector
- TV Antenna
- LP Gas Leak Detector
- Radial Tires
- Awning Rail
- Extraordinary Exterior Storage
- Tinted Windshield & Windows
- Drivers Door (Opt. on gas models, N/A on Diesel)

Your Dealer:

For further information and available floorplan options, contact your local dealer or Gulf Stream Coach, Inc. Gulf Stream Coach, Inc. reserves the right to make changes in prices, colors, materials, components and specifications and to discontinue models at without notice or obligation. Gulf Stream Coach, Inc. assumes responsibility for any error in type or print reproduction of specifications or floorplans in this brochure.
TP 15M 2/96 © 1996 Gulf Stream Coach, Inc. - Nappanee, Indiana



GULF STREAM COACH, INC.
P.O. Box 1005 • Nappanee, IN 46550

Sun Voyager

Model	8293	8313	8314	8324
FORD (CID)	N/A	N/A	460	N/A
GVWR	N/A	N/A	17,000 lb.	N/A
Front Gross Axle Weight Rating	N/A	N/A	6,000 lb.	N/A
Rear Gross Axle Weight Rating	N/A	N/A	11,000 lb.	N/A
CHEVROLET (CID)	N/A	N/A	454	N/A
GVWR	N/A	N/A	16,500 lb.	N/A
Front Gross Axle Weight Rating	N/A	N/A	5,500 lb.	N/A
Rear Gross Axle Weight Rating	N/A	N/A	11,000 lb.	N/A
SPARTAN (HP)	210/230	210/230	N/A	210/230
GVWR	19,000/23,000	19,000/23,000	N/A	19,000/23,000
Front Gross Axle Weight Rating	7,000/8,000	7,000/8,000	N/A	7,000/8,000
Rear Gross Axle Weight Rating	12,000/15,000	12,000/15,000	N/A	12,000/15,000
Wheel Base	172"	190"	190"	190"
Exterior Length	31' - 4"	32' - 10"	31' - 0"	32' - 10"
Exterior Height (w/A/C)	11' - 11"	11' - 11"	11' - 7"	11' - 11"
Overall Width	95	95	95	95
Interior Height	80	80	80	80
Interior Width	91	91	91	91
Fresh Water Tank	52	52	48	52
Gray Holding Tank	40	40	40	40
Black Holding Tank	40	40	40	40
Water Heater With DSI	6 Gal.	6 Gal.	6 Gal.	6 Gal.
Fuel Tank Capacity (Ford/GM)	N/A	N/A	75/60	N/A
Fuel Tank Capacity (Spartan: 210/230)	80	80	N/A	80

Interior and Decor

- Beautiful Sean Oak Cabinet Doors & Paneling
- Metal Drawer Guides w/Nylon Rollers
- Radius Cabinet & Wall Corners
- Windshield Privacy Drape
- Deluxe Furniture
- 3-Way Driver & Passenger Seats
- Deluxe Carpet w/Pad
- Coordinated Bedspread & Shams
- Lighted Closets
- Decorator Mirror
- Generous Overhead Storage
- Extra-Large Under-Bed Storage (most models)
- Pleated Shades

Electrical Systems

- Easy-Access Dual Battery System
- 15-Amp, 45-Amp Converter
- Electric Supply Cord
- Electric Overload Protection
- Automotive-Type, Color-Coded Wiring
- Lighted Entry & Aisle Lights
- Directional Reading/Map Lights
- Battery Disconnect

Exterior and Construction

- Unified "New Generation" Body Structure
- Radiused Laminated Rubber Roof w/Steel Rafters
- Low Profile Transition Radius Roof, Reinforced w/12-Gauge Truss-Styled Structure
- Automotive-Style Bumpers
- Hinged Exterior Storage Doors
- Heated & Fully Enclosed Holding Tanks
- Super-Structure, Steel Truss-Type Floor System
- Laminated Floors w/Metal Under-Belly
- Laminated 2" Thick Floor & Wall Construction
- High-Density Block Foam Insulation Throughout
- Molded Roof Brick Insulation, Surrounds Ducted Roof A/C
- Sidewalls Lag-bolted Every 8" to Floor Structure
- Fully Welded Steel Firewall
- Laminated Fiberglass Sidewalls
- Automotive-Styled New Exterior

Bath and Water

- Demand Water System
- City Water Hook-Up
- Dbl. Stainless Steel Sink (Kitchen)
- Sink Covers
- Tub/Shower Combination - Most Models
- Mirrored Medicine Cabinet
- Super-Flow Manifold Water Distribution System
- Deluxe Pedal Stool w/Sprayer
- Sky Dome
- Glass Shower Enclosure (8293, 8324, 8330, 8340, 8352B)

Appliances

- 3-Burner High-Performance Range
- Lighted Power Range Hood
- Dbl. Door, 2-Way Refrigerator
- Large Microwave Oven (Opt.)

Heating & A/C

- Ducted Furnace w/Elect. Ignition - 35,000 BTU (most models)
- 40,000 BTU (models: 8342, 8349)
- Pre-Wired for Ducted Roof A/C