

ENVISION

TRAVEL TRAILERS
OF EXTRAORDINARY
STYLE AND
LUXURY



SPECIFICATIONS

Specifications are approximate and subject to change. Check the weight sticker in your unit for actual weights.

	220RB	246BH	258RB	282BH	284QB	290RL	333BH
Length	27'11"	30'4"	31'5"	32'0"	34'9"	34'4"	37'6"
Width	9'6"	9'6"	9'6"	9'6"	9'6"	9'6"	9'6"
Ext. Height	11'0"	11'0"	11'0"	11'0"	11'0"	11'6"	11'6"
Int. Height	8'0"	8'0"	8'0"	8'0"	8'0"	8'0"	8'0"
Dry Weight	5,685	5,903	5,957	6,251	6,737	7,117	8,300
Hitch Weight	620	610	740	780	980	920	1,160
Net Carry Cap.	1,935	1,707	2,042	1,657	1,262	2,603	1,908
Fresh Water	51	51	51	51	51	51	51
Grey Tank	72	72	72	72	72	36	36
Black Tank	36	36	36	36	36	36	36
Furnace	20,000	20,000	35,000	35,000	35,000	35,000	35,000
Water Htr.	6 Gal	6 Gal	6 Gal	6 Gal	6 Gal	6 Gal	6 Gal
LP Tank	2 X 20	2 X 20	2 X 20	2 X 20	2 X 20	2 X 20	2 X 20

FLOOR PLANS



Scan the QR code for more images, videos, and specifications

BUILD TECH LAMINATED SIDEWALLS

Using processes perfected through years of innovation, our laminated sidewalls combine a light yet resilient welded square-tube aluminum frame and exterior fiberglass with structural, insulating, and decorative layers using advanced heat-resistant adhesives in a vacuum chamber where the layers are bonded into a remarkably light, incredibly strong unit.

- 1 Gleaming exterior fiberglass
- 2 AZDEL synthetic composite
- 3 Rigid closed-cell foam insulation
- 4 Welded square-tube aluminum skeleton frame
- 5 Structural plywood inner wall
- 6 Decorative easy-care vinyl wallcovering

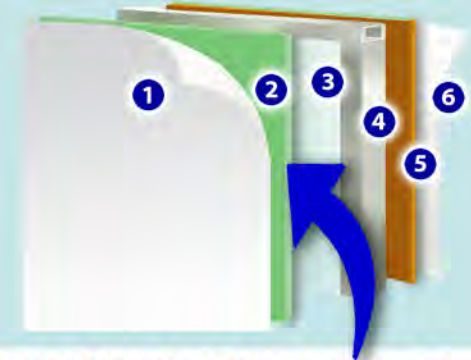

THE AZDEL ADVANTAGE

Key to ENVISION vacuum-bonded sidewalls is a structural layer of AZDEL synthetic composite. AZDEL can't absorb moisture, so it won't rot or mildew, and can't delaminate. It insulates against extremes of temperature and noise, contains no formaldehyde, and weighs half as much as the wood it replaces.

ENVISION

STANDARD FEATURES

Interior

- 'Matador Frost' Ceiling Panels
- 'Plush Dunes' Wall Vinyl
- Cabinetry w/Solid Wood Stiles & Cabinet Doors
- Designer Window Treatments

Heating, Cooling, Electrical

- Cool, efficient Interior LED Lighting
- LED Motion Sensor Lighting in Pass-Through Storage Area
- Central Command Switch Panel w/Monitor
- Multiple USB Charging Ports
- LED Motion Sensor Entry Light
- Tech-Ready Features:
 - Wi-Fi Ready
 - Cable and Satellite Connections
 - Solar Panel Ready
 - Back-Up Camera Prep
- Dump Valve Light
- 35-Amp Converter w/Charger & LED Indicators
- 30 ft. Detachable 30 Amp Power Cord

Safety

- Safety Chains
- Break-Away Switch
- Wall Mount Fire Extinguisher
- Combo LP and CO Detector
- Smoke Detector
- Exterior LP Gas Hookup

Bath

- Foot Flush Toilet
- Vortex Bath Fan
- Medicine Cabinet with Mirror
- 30" x 36" Walk-In Shower w/Door (220RB, 246BH, 258RB, 282BH, 290RL)
- 24" x 26" Bathtub with Surround and Tub/Shower Doors (284QB)
- Neo-Angle Corner Shower (333BH)
- Skylight in Shower/Tub

Appliances

- Stainless Steel 3-Burner Range w/Oven & Glass Cover
- Stainless Steel Microwave Oven
- Stainless Steel Range Hood w/Light
- 12V 10.7 cu. ft. Stainless Steel Everchill Refrigerator/Freezer
- Prep for Outdoor Gas Grill

Windows and Doors

- Friction Hinge Entry Door(s)
- Black Radius Tinted Windows
- Radius Compartment Doors with Magnetic Catch Latches

Furnishings

- Designer Window Treatments
- Booth Dinette (258RB, 282BH, 284QB, 290RL, 333BH)
- U-Shaped Dinette (246BH)
- Tri-Fold Sofa (258RB, 282BH, 284QB, 290RL)
- L-Shaped Lounge w/Folding Table (220RB)
- Bunk Beds w/Poly Mattresses (246BH, 282BH, 284QB, 333BH)
- Kid's Dinette/Game Table (284QB, 333BH)
- 60" x 80" Queen Bed
- Designer Bedspread
- Under-Bed Shoe Storage

Exterior

- One-Piece Vinyl Roof
- Fiberglass Exterior Sidewalls w/AZDEL
- Easy-Lube Axles
- (2) 20 lb. LP Bottles w/Cover
- Gutter Rail & Rain Spouts at Roofline
- Radial Tires w/Aluminum Rims
- Outside Convenience/Snack Center (246BH, 282BH)
- Outside Kitchen (333BH)

POPULAR OPTIONS

- Free-Standing Table with 4 Chairs
- 2nd Air Conditioner (13,500 BTU, 50 Amp Service required)
- (4) Electric Stabilizer Jacks
- Electric Fireplace/Heater
- Theater Seating in place of Tri-Fold Sofa
- 8 cu. ft. 3-Way Refrigerator in place of 12V Everchill (6 cu. ft. in 220RB, 246BH, 290RL)
- Painted Front Cap

INCLUDED LUXURY ITEMS

ENVISION Power Package (Included)

- Power Tongue Jack
- Power Awning w/LED Lighting
- Blue Tooth Stereo System w/Sound Bar
- Marine Grade Exterior LED Speakers
- 15,000 BTU Ducted Air Conditioning
- LED Exterior Clearance & Tail Lights
- 40" LED TV w/Interior & Exterior Mounting Brackets (N/A 284QB,333BH)
- 50" LED TV w/Interior & Exterior Mounting Brackets (284QB, 333BH)

Worry-Free Camping Package (Incl.)

- Fold-Down Solid-Step
- Fold-Away Safety Grab Handle
- Walk-On Roof w/Ladder
- Exterior Docking Station for Utility Hookups
- Gas/Electric DSI Water Heater
- Spare Tire with Carrier
- Black Tank Flush
- Fiberglass Front Cap w/LED Lights
- Front Diamond Plate Rock Guard
- Slam-Latch Cargo Doors; Magnetic Catches

Silver Lining Climate Package (Incl.)

- Heated/Enclosed Underbelly w/Dedicated Heat Duct
- Double-Wrapped Radius Roof & Floor
- 35,000 BTU Gas Furnace

Chef's Best Kitchen (Included)

- Industrial Stainless Steel Sink w/Cover
- Pull-Down Faucet w/Sprayer
- Easy-Clean Seamless Countertops
- Solid-Surface Kitchen Countertop
- Backsplash behind Range

EMPEROR OPTION

- 72" x 80" King Size Bed for Master Bedroom



THE ENVISION 3-YEAR WARRANTY

Our exclusive 3-year Limited Warranty gives you peace of mind by covering key structural components (floor, roof, side, front, and rear walls) of your new ENVISION travel trailer. In addition, suppliers of other key components also provide enhanced coverage to Gulf Stream Coach customers.

Check the full written warranty for complete information.

For more information see your Gulf Stream Coach Dealer or visit www.gulfstreamcoach.com. Features, specifications, materials, and components are subject to change without further notice. Not responsible for typographical errors. Photos may show optional features.

© 2021 Gulf Stream Coach, Inc., Nappanee, IN, USA • ENV122021

Your Gulf Stream Coach Dealer:

QUALITY • VALUE • INNOVATION

505 S Oakland Avenue • Nappanee, IN • 46550
www.gulfstreamcoach.com



ENVISION

SVT SPECIAL VALUE SERIES



- Laminated construction with Azdel synthetic composite substrate
- Lightweight welded aluminum frames
- Fully equipped under 4,000 lbs.
- Full 8' wide for more living space
- Well-equipped
- Perfect for downsizers & new RVers
- Flexible, proven, much-loved floor plans

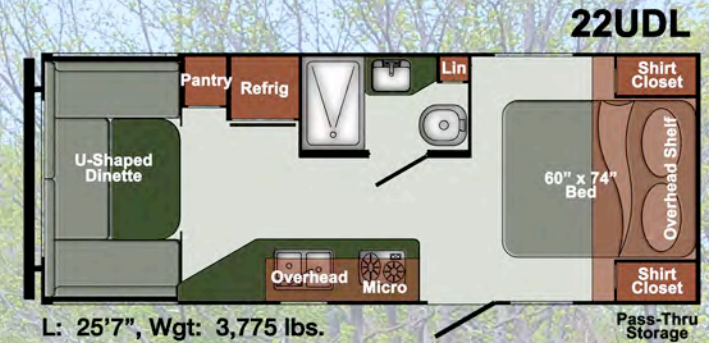
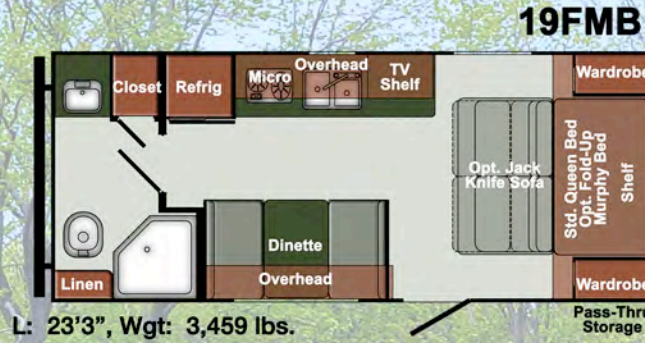
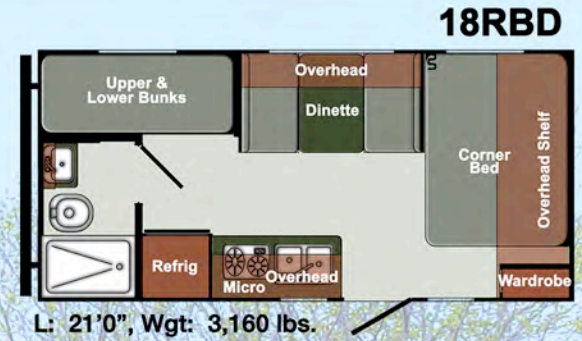

SVT90 90" WIDE, DOUBLE AXLES

- Laminated construction w/Azdel synthetic composite substrate
- Tons of storage, lots of windows
- Fully equipped under 3,850 lbs.
- 2,800 lb. double axles
- Pass-through storage
- Handy galley kitchen w/big double-bowl sink
- Roomy bath, HUGE shower
- Everything a camping couple needs

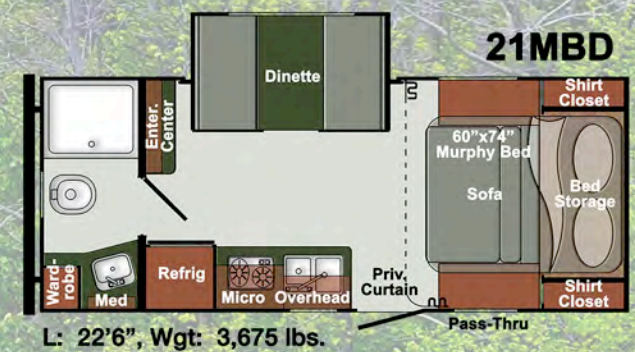
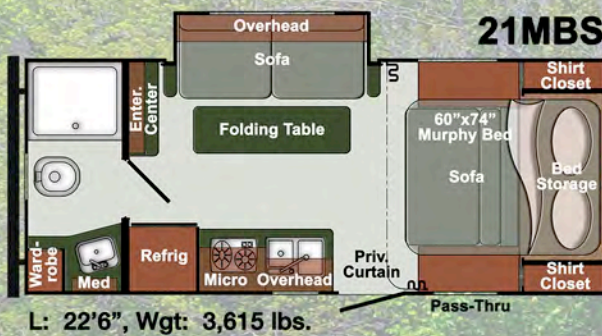
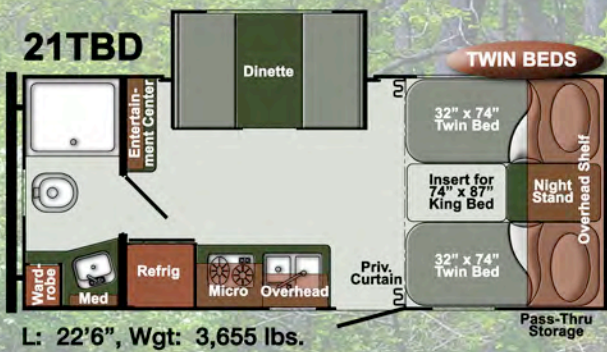
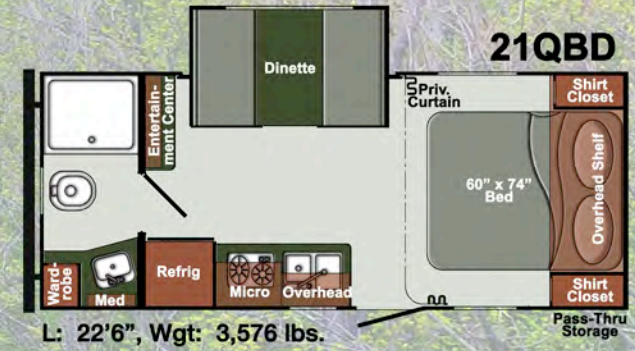
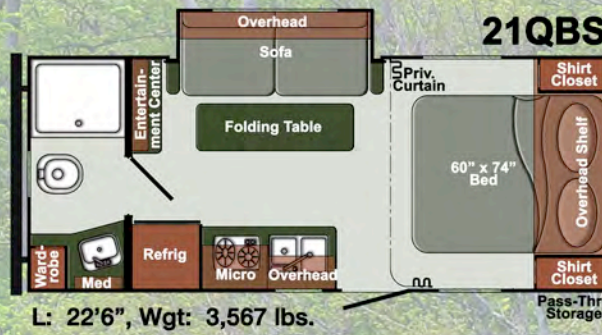

ENVISION SVT SPECIAL VALUE SERIES



SVT STANDARD FEATURES

DECOR

- Designer Window Treatment
- Mini-Blinds throughout
- Easy-Care Vinyl Flooring
- Matador Frost Ceiling Panel
- Lumbercore Solid Wood Cabinet Stiles
- Antique Topaz Laminated Counters
- Wood Cabinet Doors
- Easy-Care Wall Vinyl
- Accent Wall in Slide-Out

HEATING & COOLING

- Prewired for Roof A/C
- Gas Furnace
 - 16,000 BTU 18RBD, 19FMB, all SVT90
 - 20,000 BTU 22UDL
- 6 Gal DSI Water Heater

SAFETY, MISCELLANEOUS

- Double Entry Step
- Breakaway Switch
- Safety Chains
- Wall-Mount Fire Extinguisher
- Combo LP & CO Detector
- Smoke Detector

ELECTRICAL

- TV Antenna w/Power Booster
- Intellitank Monitor Panel
- 30 Amp 35' Power Cord w/Storage
- 35 Amp Converter w/Charger & LED Indicators

WINDOWS & DOORS

- 26" x 70" Radius Entry Door w/Deadbolt Lock & Friction Hinge
- Black Radius Tinted Windows
- Deluxe Slam-Latch Luggage Doors

BATH

- Foot Flush Toilet
- Power Bath Vent
- Medicine Cabinet w/Mirror
- Shower Curtain
- Neo-Angle Shower (19FMB) or Bath Tub (18RBD, 22UDL)
- 30" x 36" Walk-In Shower (SVT90)

FURNISHINGS

- Booth Dinette (18RBD, 19FMB, 21TBD, 21QBD, 21MBD) or U-Shaped Dinette (22UDL)
- 60" x 74" Bed w/Poly Mattress (19FMB, 21QBD, 21QBS, 22UDL) or 54" x 74" Bed w/Mattress (18RBD)
- Murphy Bed (21MBS, 21MBD)
- Twin Beds (21TBD)
- 24" x 74" Bunk Beds w/Poly Bunk Mattresses (18RBD)

APPLIANCES

- 2-Burner Gas Range Top
- Power Range Hood w/Light
- 6.0 cf Double-Door Refrigerator

EXTERIOR

- One-Piece Vinyl Roof
- Rain Gutter Rail above Slide-Out
- Deluxe Laminated Fiberglass Exterior Walls w/Azdel Substrate
- Manual Patio Awning
- (4) Manual Stabilizer Jacks
- Radial Tires w/Modular Rims
- 2 x 20 lb. LP Tanks

POPULAR OPTIONS

- Electric Awning w/LED Lights & Speakers (required)
- 13,500 BTU Roof Air Conditioner
- Microwave Oven
- Premium Foam Mattress
- Blue Tooth Stereo Home Theater
- Outside Spray Port
- Fold-Away Grab Handle
- Interior & Exterior TV Mounts
- Murphy Bed (19FMB)
- 3-Burner Range w/Oven
- Night Shades
- Black Tank Flush
- Spare Tire w/Carrier
- Aluminum Wheels & Radial Tires
- Power Tongue Jack

SPECIFICATIONS

Model	18RBD	19FMB	22UDL	21MBS	21MBD	21QBS	21QBD	21TBD
Length	21'1"	23'3"	25'5"	22'6"	22'6"	22'6"	22'6"	22'6"
Width	96"	96"	96"	90"	90"	90"	90"	90"
Ext. Height	10'4"	10'6"	10'6"	10'6"	10'6"	10'6"	10'6"	10'6"
Int. Height	80"	80"	80"	80"	80"	80"	80"	80"
Base Weight	3,160	3,459	3,775	3,615	3,675	3,567	3,576	3,655
Hitch Weight	320	370	420	460	460	440	420	460
Net Carry Cap.	740	1,311	3,665	2,445	2,385	2,473	2,444	2,405
Fresh Water	29	54	54	54	54	54	54	54
Grey Tank	33	33	33	33	33	33	33	33
Black Tank	33	33	33	33	33	33	33	33
Furnace	16,000	16,000	20,000	16,000	16,000	16,000	16,000	16,000
Water Heater	6 Gal	6 Gal	6 Gal	6 Gal	6 Gal	6 Gal	6 Gal	6 Gal
LP Tank	2 x 20	2 x 20	2 x 20	2 x 20	2 x 20	2 x 20	2 x 20	2 x 20

Relax - You're Covered! With Our Exclusive Three-Year Limited Structural Warranty

In addition to a standard one-year warranty against defects in materials and/or workmanship in construction and original components under normal use, our exclusive Gulf Stream Coach Warranty gives you THREE YEARS of coverage on key structural components (sidewalls, front and rear walls, roof, and floor) of your new travel trailer.

In addition, extended protection is offered by many manufacturers that supply components for Ultra-Lite units, including the refrigerator, antenna, furnace, water heater, awning, air conditioner, range, microwave, and more. See the full warranty statement for details.

Your Gulf Stream Coach Dealer



QUALITY • VALUE • INNOVATION

www.gulfstreamcoach.com • 503 South Oakland Avenue, Nappanee IN 46550

Materials, specifications, standard features, & options are subject to change. Contact your dealer or visit www.gulfstreamcoach.com for more information. #ENVSVT112022

ENVISION

SIGNATURE SERIES

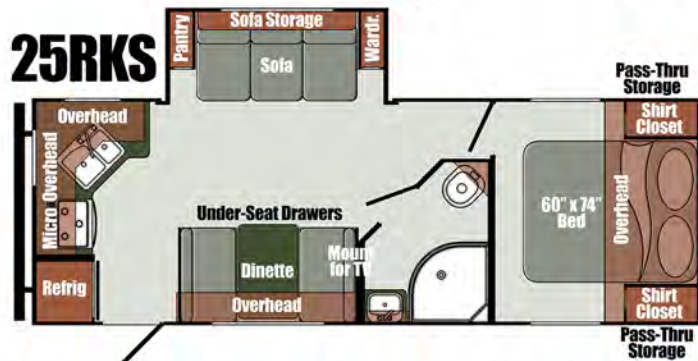
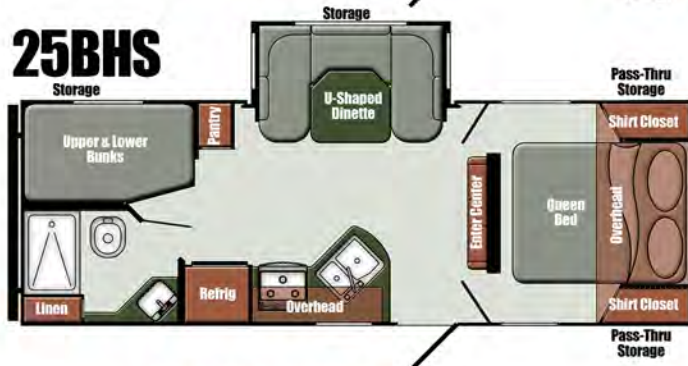
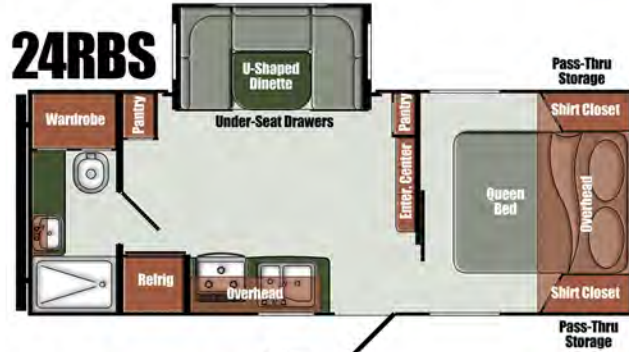

Specifications

	Length	Width	Ext. Hgt	Int. Hgt	Dry Wgt.	Hitch Wgt.	Carry Cap.	Fresh Water	Grey Tank	Black Tank	Furnace	Water Htr.	LP Tank
Weights include typical options, and are approximate. Check the sticker in each unit for actual weights.													
24RBS	24'8"	96"	11'3"	80"	4,700	530	2,340	36	29	29	20,000	6	2 x 20
25BHS	27'2"	96"	11'0"	80"	5,040	540	2,000	36	29	29	20,000	6	2 x 20
25RKS	27'4"	96"	11'1"	80"	TBD	TBD	TBD	36	58	29	20,000	6	2 x 20
25RLD	28'0"	96"	11'0"	80"	4,911	590	2,639	36	29	29	20,000	6	2 x 20
28CRB	30'3"	96"	10'11"	80"	6,120	520	1,400	36	29	29	30,000	6	2 x 20
28BBS	31'2"	96"	11'0"	80"	5,820	640	1,220	36	29	29	30,000	6	2 x 20



ENVISION

SIGNATURE SERIES

STANDARD FEATURES

Interior

- Vintage Wash Ceiling Panels
- Solid Wood Core Cabinet Stiles
- Wood Cabinet Doors
- High-Performance Laminated Countertops with continuous-edge Moulding
- Royal Silk Easy-Care Wall Vinyl
- Accent Walls in Slide-Outs
- High-Performance Vinyl Flooring
- Designer Window Treatment
- Soft-Pleated Night Shades

Heating & Cooling

- Pre-wired for Roof A/C
- Ducted AC Prep
- Gas Furnace w/Wall Thermostat
- Gas Water Heater

Safety

- Triple Entry Step
- Break-Away Switch
- Safety Chains
- Wall-Mount Fire Extinguisher
- Combo LP & CO Detector
- Smoke Detector

Electrical

- Satellite-Ready Prep
- LED Light in Pass-Through
- System Monitor Panel
- TV Antenna w/Power Booster
- LED Step Light w/Switch
- Solar-Ready Prep
- 30 AMP 35' Power Cord w/Storage
- 55 Amp Converter w/Charger & LED Indicators

Furnishings

- Jackknife Sofa (28BBS)
- 60" x 74" Bed w/Poly Mattress
- Upper & Lower Bunk Beds (25BHS, 28BBS)

Bath

- Foot Flush Toilet
- Power Bath Vent
- Medicine Cabinet w/Mirror
- Shower Curtain
- 24" x 36" Shower
- Skylight

Kitchen Appliances

- Power Range Hood w/Light
- 6.0 cu. ft. 2-Door Refrigerator
- 2-Burner Gas Cooktop

Windows & Doors

- Friction Hinge Entry Door
- Black Radius Tinted Windows
- Radius Compartment Doors w/Slam Latches

Exterior

- One-Piece Vinyl Roof
- Fiberglass Exterior Sidewalls
- Easy Lube Axles
- Radius Metal & Fender Skirts
- 14" Radial Tires, Modular Rims
- Manual Awning
- Deluxe Slam-Latch Compartment Doors
- (4) Manual Stabilizer Jacks

PACKAGES & OPTIONS

Included/Required Options

- Electric Awning w/LED Lights
- Microwave Oven
- 13,500 BTU Roof A/C
- Molded Shower Surround
- 3-Burner Gas Range w/Oven
- Blue Tooth Home Theater Stereo w/Speakers

Popular Build Options

- Interior & Exterior TV Mounting Brackets
- Bumper-Mount Gas Grill
- Electric Stabilizer Jacks
- Power Tongue Jack
- HDMI LED TV (19", 32", 40")

Popular Options (Cont'd)

- 15,000 BTU A/C in place of 13,500 BTU
- Premium Upgrade Mattress
- 14" Spare Tire w/Carrier
- 14" Aluminum Wheels
- Outside Spray Port
- 6 Gal DSi Gas/Electric Water Heater
- 60/40 Sink Cover
- Range Cover
- 8 cu. ft. 2-Door Refrigerator
- Enclosed Underbelly
- Electric Fireplace
- Fold-Away Grab Handle
- Black Tank Flush

