

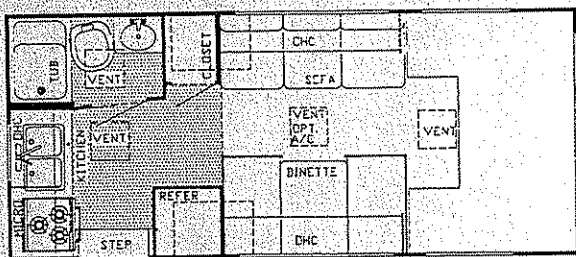

CONQUEST

1000 Series

BY GULF STREAM®



Model 6200

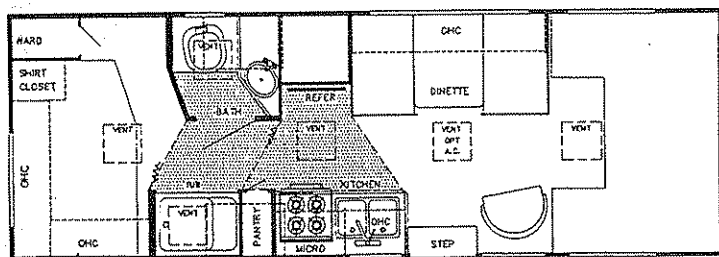

Model 6242

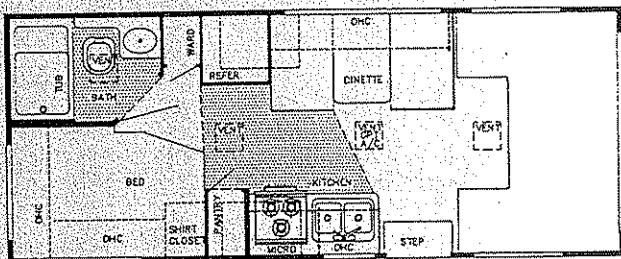

Model 6210

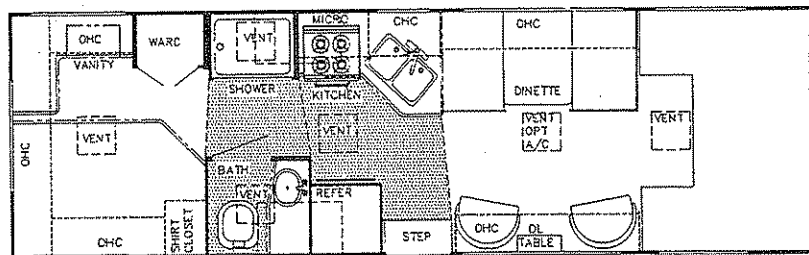

Model 6262 (Twin Beds, or Bunks Opt., Sofa Opt. p/o chairs)

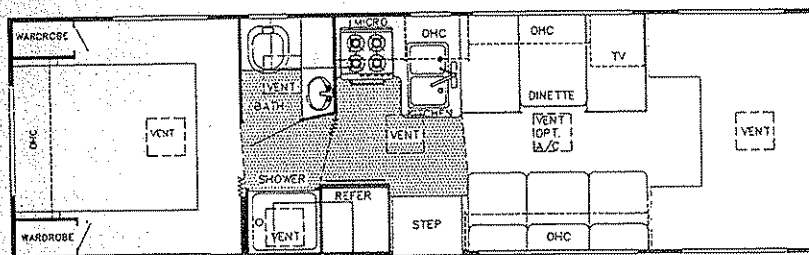

Model 6272 (Twin Beds, Slider Bed, or Bunks Opt.)

1000 Series

by GULF STREAM®

Conquest Standard Specifications

Interior and Decor

- o 6'-8" Interior Height (Most Models)
- o Stile Constructed Cabinetry
- o Raised Panel Cabinet Doors
- o Privacy Curtain Cab
- o Deluxe Carpet w/Pad Throughout
- o Generous Overhead Storage
- o 3-Way Driver & Passenger Seat
- o Coordinated Bedspreads & Shams (opt.)
- o Decorator Curtains & Shades w/ Valances
- o Queen Size Bed, Cab-Over
- o Power Vent in Commode
- o Tile Tub Surround

Electrical Systems

- o Easy Store 25' Elect. Power Cord
- o Overhead Reading Lights
- o 110-Volt Receptacles
- o Ground Fault Circuit Interrupter
- o Well Illuminated Interiors
- o Outside Receptacle
- o TV Antenna w/Amp & Boost
- o Auxiliary Battery
- o Converter w/Charger
- o Generator Prep
- o AM/FM Cassette w/4 Speakers
- o Monitor Panel

YOUR DEALER

Exterior and Construction

- o Welded Aluminum Cage Construction
- o 4-Ply Laminated Walls, Roof & Floor
- o Dura-Tech Fiberglass Exterior
- o Laminated Rubber Roof w/ Heliarc-Welded Aluminum Rafters
- o Tubular Steel Floor
- o Laminated Floor w/ Metal Underbelly
- o Foamed, Sealed & Undercoated
- o Generous Above-Floor Exterior Storage
- o Partial Basement Storage Available (some models)
- o Distinctive Exterior Graphics
- o Expansive Radius Slider Windows
- o Hose Storage Bumper
- o Self Storing Entry Step
- o Front Cab-Over Window
- o Outside Grab Handle
- o Porch Light
- o Dead Bolt on Entry door
- o Spare Tire Carrier
- o Mag-Look Wheel Covers

Bath and Water

- o Demand Water System
- o City Water Hook-Up
- o Tub/Shower Combo
- o Lavatory w/Base Cabinet Storage

Ford Chassis

- o 6.8L, V-10 Engine
- o 5.6L available on 20' & 21'
- o 4 Speed Auto. Overdrive Trans.
- o Tilt Wheel Steering
- o Power Brakes & Steering
- o Dual Air Bags
- o Deluxe Exterior Mirrors
- o Radial Tires
- o Cruise Control
- o Gas Tank -
- o Approx. 35 Gal. (20' - 21')
- o Approx. 55 Gal. (23' & Larger)
- o FORD Turbo Diesel Chassis Opt

Appliances

- o 3-Burner Range
- o Large 2-Way Sgl. Door Refer.(20' - 21')
- o Large 2-Way Dbl. Door Refer.(23' - 27')
- o 6 Gal. Elect. Ign. Water Heater
- o 25,000 BTU Furnace
- o 13,500 BTU Roof Air
- o Large LP Gas Tank
- o Carbon Monoxide Detector

Popular Options

- o Rear Ladder
- o Chrome Bumper Cover
- o Aluminum Running Boards
- o Deluxe Awning
- o Microwave Installed

MODEL	Chassis	Wheel Base	GVWR	GCVW	*Length	*Height (w/A/C)	*Black	*Gray	*Fresh	LP Tank
6200	Ford E-350 V-10/5.4L Opt.	138	10,500	20,000	20' - 8"	10' - 7"	19	19	20	42 lb.
6210	Ford E-350 V-10/5.4L Opt.	138	10,500	20,000	22' - 2"	10' - 9"	16	20	29	42 lb.
6242	Ford E-350 V-10	176	11,500	20,000	26' - 4"	10' - 8"	19	25	38	42 lb.
6262	Ford E-350 V-10	186	11,500	20,000	28' - 0"	11' - 3"	46	46	47	42 lb.
6272	Ford E-350 V-10	186	11,500	20,000	28' - 0"	11' - 3"	46	46	47	42 lb.

* - Approximate, and subject to change without notice.



GULF STREAM COACH, INC.
P.O. BOX 1005 • NAPPANEE, IN 46550

Gulf Stream Coach, Inc. reserves the right to make changes in prices, colors, materials, components and specifications and to discontinue models at any time without notice or obligation. Gulf Stream Coach, Inc. assumes no responsibility for any error in type or print reproduction of specifications or floorplans in this brochure. TP 10M 1/97