

SCENIC CRUISER

GULF STREAM

COACH, INC.

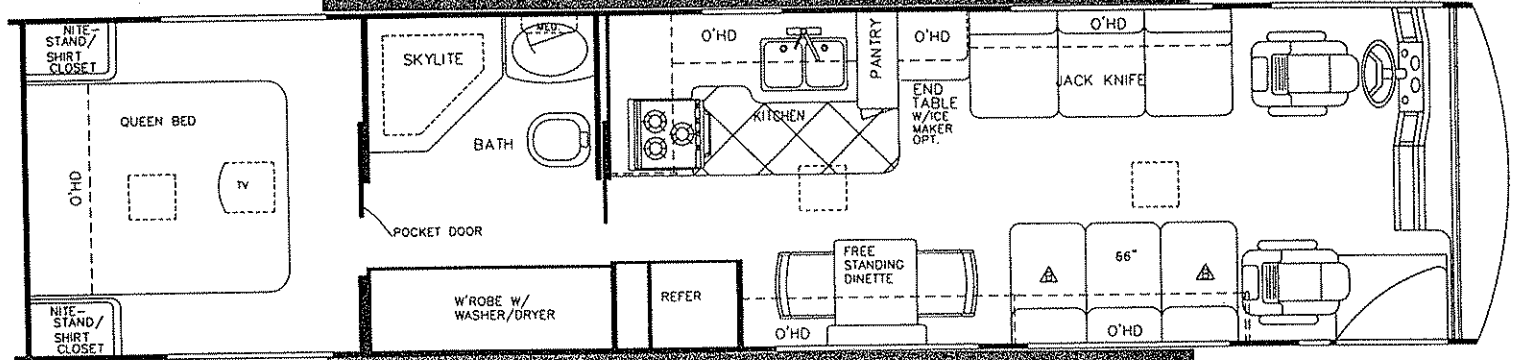

Model 8360 DIESEL

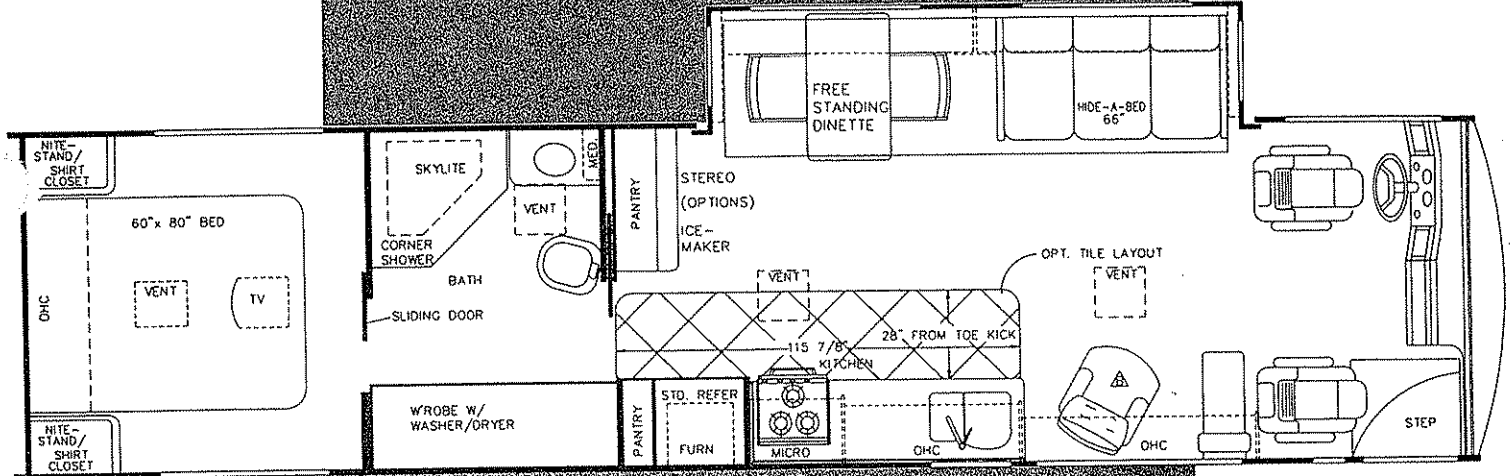
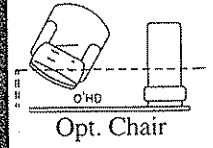

Model 8361 DIESEL

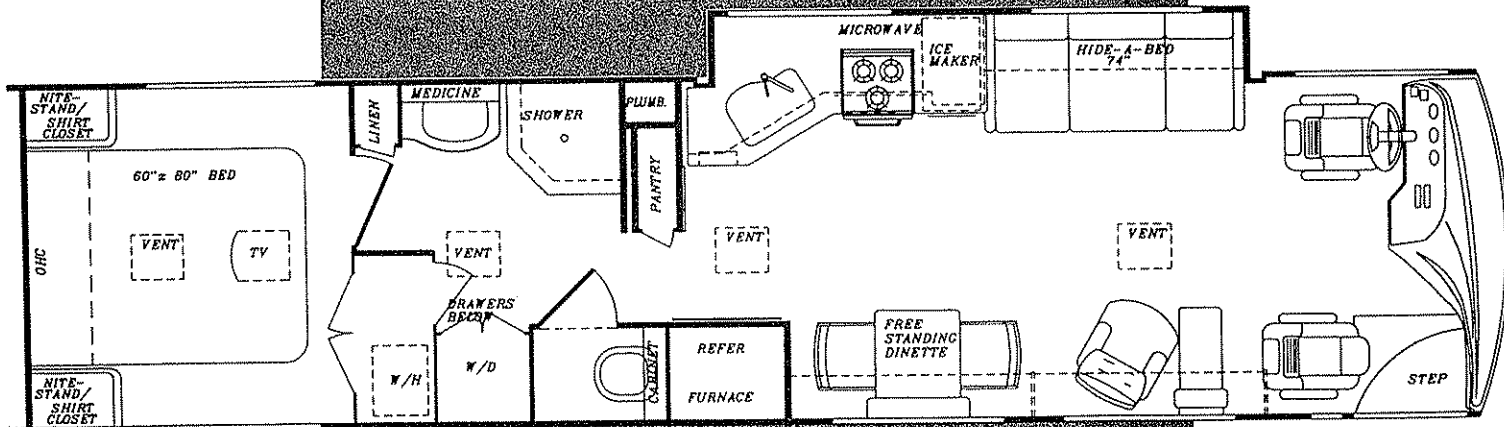

Model 8362 DIESEL

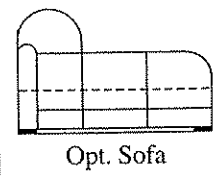

SCENIC CRUISER®

GULF STREAM

COACH, INC.

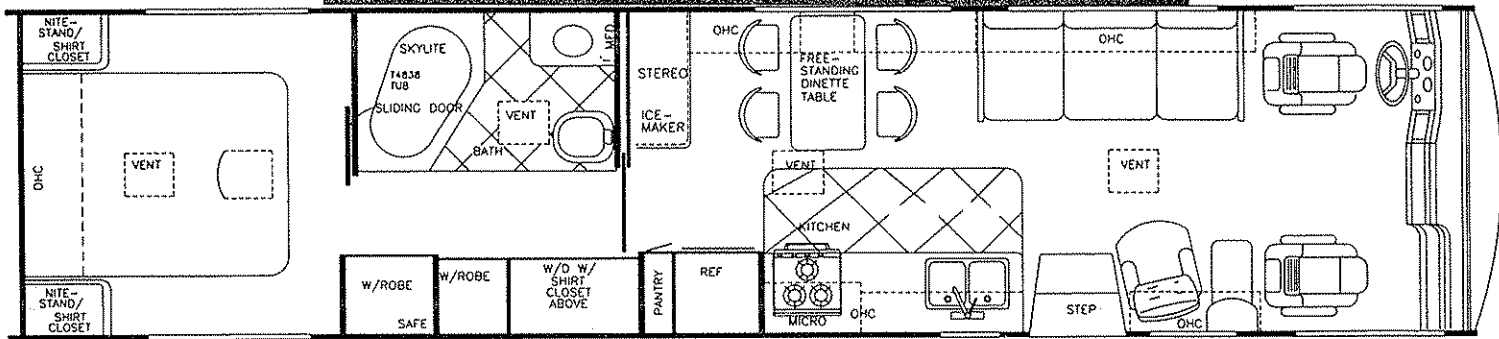

Model 8380 DIESEL

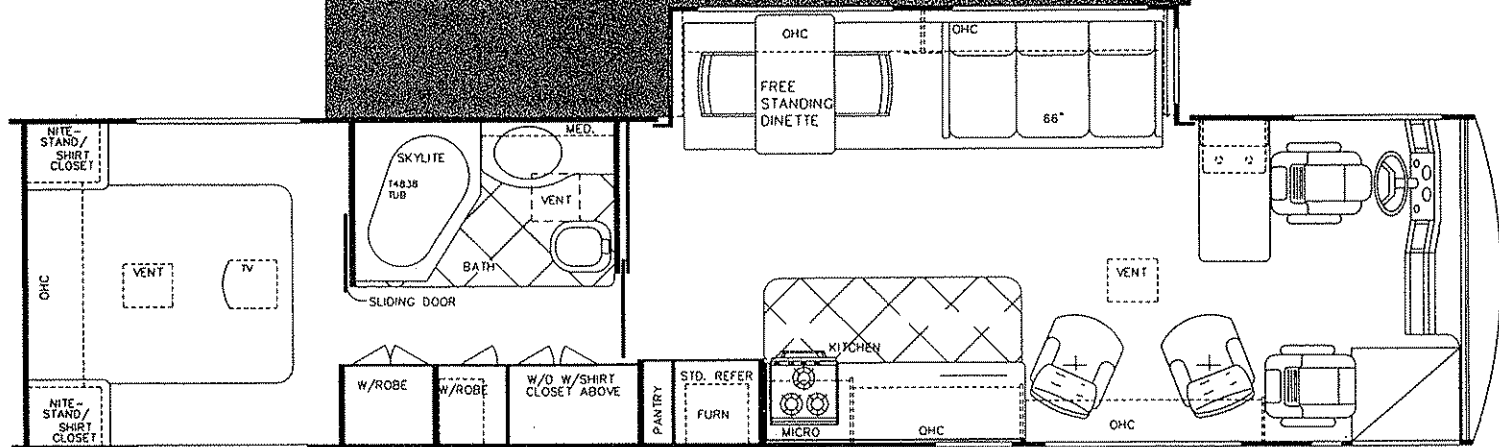

Model 8381 DIESEL

GULF STREAM'S NEW GENERATION CRADLE OF STRENGTH

1. Seamless Rubber Roof For Greater Energy Efficiency and Dependability.

2. Luan Decking for Additional Strength.

3. Molded E.P.S. Brick Insulation Provides Consistent Insulative Value As Well As Superior Dimensional Rigidity.

4. One-Piece Formed Aluminum Air Conditioning Duct, Completely Surrounded By Polystyrene Insulation.

5. Bubble-Wrapped Foil Insulation Provides Superior Insulation.

6. Rugged Welded Tube Roof Framing.

7. Soft Touch Ceiling Fabric for Added Sound Insulation.

8. Aluminum Cove Molding.

9. Bubble-Wrapped Foil Insulation Minimizes Thermal Transfer.

10. Rugged Roll-Formed Steel Roof-to-Sidewall Transition Member Insures Structural Integrity and Stability.

11. Die-Stamped Steel Transition Member Gusseting Provides Greater Strength and Structural Integrity.

12. Rugged Heavy-Gauge Tubing, Fixture Welded to Form the Sidewall Framing.

13. High-Density E.P.S. Insulation Provides Superior Laminating and Bonding Characteristics and Insures Greater Energy Efficiency.

14. Interior Wall Panels Securely Laminated to Sidewall Framing.

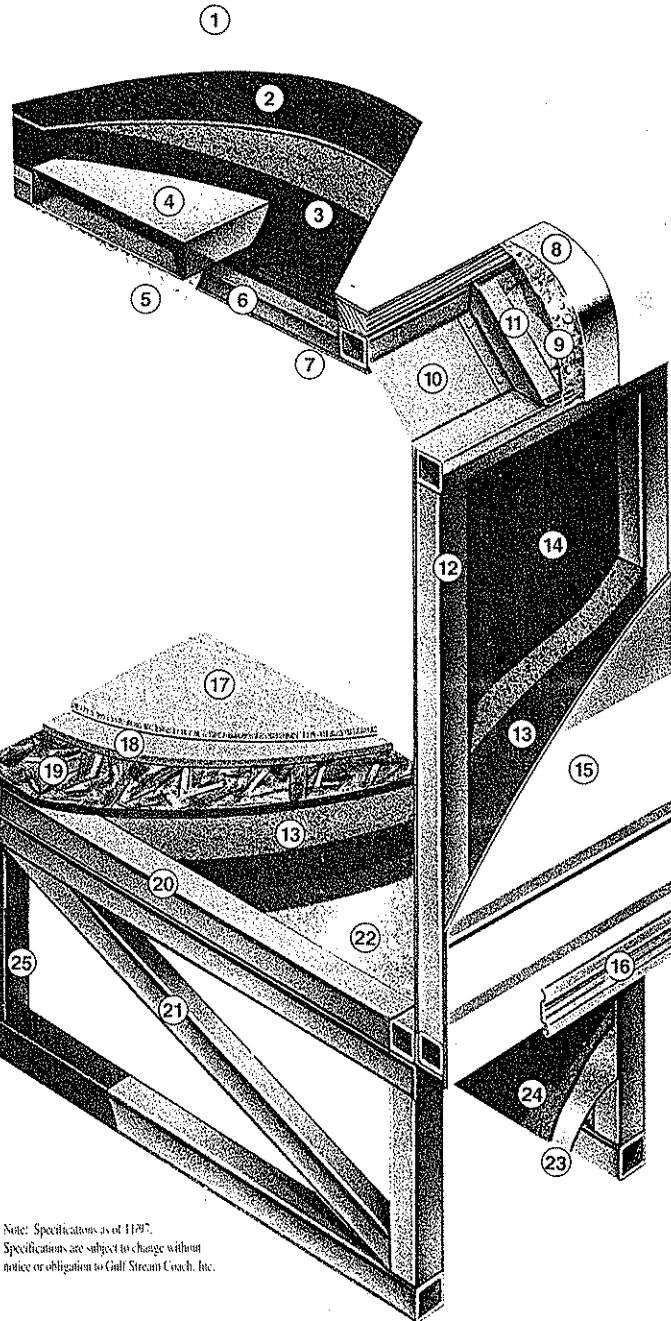

Note: Specifications as of 11/97.
Specifications are subject to change without notice or obligation to Gulf Stream Coach, Inc.

15. "Mende" Fiberglass Exterior, Vacuum-Bond Laminated to Sidewall Framing for Lasting Beauty and Durability.

16. Aluminum Trunk Door Hinge Extrusion Provides A Tight Seal Discouraging Air or Water Infiltration.

17. High-Quality Stain-Resistant Carpeting Available in Designer-Coordinated Colors.

18. Extra-Thick Padding Under Carpet Provides Extra Comfort and Increases Carpet Durability.

19. Continuous Structurwood Floor Decking Laminated to Steel Floor Structure Assures a Quiet, Long-Lasting, Rigid Floor

20. Heavy-Gauge Steel Tube Frame Fixture Welded for Extra Strength and Stability.

21. Heavy-Gauge Steel Tube Framing, Fixture Welded Floor Truss System Provides the Strongest Motorhome Foundation in the Industry.

22. Seamless Layer of Galvanized Steel Securely Laminated to the Steel Floor Framing.

23. Galvanized Steel Used to Form Each Storage & Holding Compartment.

24. Durable All-Weather Carpeting Completes Each Accessible Storage Compartment, Providing Extra Protection for Luggage and Valuables.

25. Rust-Prohibitive Paint Coating Applied to All Steel Framing Assures Corrosion and Rust Protection.



GULF STREAM - BUILT TO LAST!

SPECIFICATIONS

DIESEL MODELS	8360	8361	8362	8380	8381
Chassis:	SPARTAN ALPINE	SPARTAN ALPINE	SPARTAN ALPINE	SPARTAN MTN MASTER	SPARTAN MTN MASTER
Engine (HP)	275	275	275	325	325
Wheelbase	234"	234"	234"	252"	252"
GVWR (lbs.)	26,000	26,000	26,000	29,400	29,400
DIMENSIONS:					
Overall Length (approx.)	37' 6"	37' 6"	37' 6"	39' 0"	39' 0"
Overall Height w/Roof A/C	12' 0"	12' 0"	12' 0"	12' 1"	12' 1"
Overall Width	101"	101"	101"	101"	101"
Interior Height	80"	80"	80"	80"	80"
Interior Width	97"	97"	97"	97"	97"
CAPACITIES:					
Fresh Water Tank (Gal.)	100	100	100	100	100
Grey Holding Tank (Gal.)	50	50	50	50	50
Black Holding Tank (Gal.)	50	50	50	50	50
Water Heater w/DSI (Gal.)	10	10	10	10	10
LP Gas Tank (lbs.)	150	150	150	150	150
Fuel Tank (Gal.)	100	100	100	100	100
Furnace (BTU's)	40K	40K	40K	40K	40K

Deluxe Std. Features

- Auto Dash Air Conditioner
- Auto Cruise Control
- Stainless Steel Wheel Inserts
- Rally Hook-Up
- Electric Step
- Rear Ladder
- Floor Mats
- Super Slick Exterior Fiberglass
- AM/FM Cassette w/4 Spkrs.
- Monitor Panel in Range Hood
- 150 lb. LP Tank
- Radial Tires
- Tinted Windshield & Windows
- Wall Safe
- Lighted Entry Step
- Driving Lights

Electrical Systems

- Easy-Access Dual Battery System
- Power Vent in Bath and Kitchen
- Electric Supply Cord
- Electric Overload Protection
- Automotive Color-Coded Wiring
- Lighted Entry & Aisle Lights
- 12V, 45-Amp Converter w/Battery Charger

Interior and Decor

- Mirage Ivory or Oak Cabinetry w/Etched Glass Doors in Living Room & Bath
- Solid Surface Kitchen Countertop w/Backsplash and Knife Holder
- Custom Padded Dash w/Illuminated Gauges
- Day/Night Pleated Shades in LVRM & BDRM
- Pleated Privacy Curtain
- 3-Way, Feather Touch Captains Chairs
- Deluxe Furniture Package
- Deluxe Door and Window Drapes
- Coordinated Bedspread and Shams
- Generous Overhead Storage Compartments
- Free Standing Dinette and 2 Chairs (most models)
- Queen Size Bed w/Deluxe Innerspring Mattress
- Mini-Blinds in Kitchen
- Mirrored Closet Doors
- Heavy Duty Clear Vinyl Runner Over Carpet

Appliances

- Deluxe 3-Burner High-Performance Range w/Oven
- Lighted Power Range Hood
- 19" Color TV (VCR Ready)
- TV Antenna w/Amp, Boost and 2 Jacks
- 2-Door, 2-Way Refrigerator
- LP Gas Leak Detector
- Carbon Monoxide Detector

Heating and Air Conditioning

- Ducted Furnace w/Elect. Ignition
- 40,000 BTU (most models)
- Pre-Wired for Ducted Roof A/C

Exterior and Construction

- Unified "New Generation" Body Structure, Providing a Cradle of Strength:
 - 1-1/2" x 1-1/2" Tubular Steel Sub-Floor Trusses
 - 1-1/2" x 1-1/2" Tubular Steel Floor Framing
 - Vacuum-Bond Laminated Floor w/Metal Under-Belly
 - Vacuum Bond Laminated Sidewalls w/Tubular Metal Framing and One Piece Fiberglass w/Mende Backer
 - Vacuum Bond Laminated Roof w/Tubular Metal Framing, and Roof Brick Block Foam Insulation Throughout
- One-Piece, Radiused Rubber Roof w/12 Year Warranty
- Virtually Seamless Weyerhaeuser Structurwood Floor Decking w/10 Year Warranty
- Angled Steel Sidewall-to-Roof Transition Member
- Upgrade Hinged Exterior Storage Doors
- Heated & Fully Enclosed Holding Tanks
- High-Density Block Foam Insulation Throughout
- Molded Roof Brick Insulation, Surrounds Ducted Roof A/C
- Sidewalls Lag-bolted Every 8" to Floor Structure
- Fully Welded Steel Firewall
- Rear Fiberglass Cap with Integrated Bumper
- Outstanding Side-to-Side, Carpeted and Lighted Exterior Pass-Through Storage
- Radius Entry Door w/Deadbolt Lock
- Sealed Perimeter and Engine Compartment
- Large Panoramic Windshield
- Deluxe Outside Mirrors
- Jalousie Windows in Bedroom

Chassis (Diesel Models)

- Spartan ALPINE Chassis, w/Cummins 6CTA 8.3, 275HP, 800 ft. lb. Torque Turbo-Charged Rear Mounted Diesel Engine (36' models)
- Allison MD-3060P 6-Speed, Electronically Shifted Automatic Transmission
- Full Air-Ride Suspension
- Full Air Brakes
- High Capacity Automotive Heater
- Tilt Steering Wheel
- PAC Brake
- *38' Models ONLY: MOUNTAIN MASTER Chassis Featuring Cummins 8.3 Litre, Turbo-Charged 325 HP Diesel Engine, 915 ft. lb. Torque, Side-Mounted Radiator*

Bath and Water

- Super-Flow Manifold Water Distribution System
- Demand Water System
- City Water Hook-Up
- Double Stainless Steel Sink (Kitchen)
- White Single Lever Kitchen Faucet
- Sink Covers
- Gold Neo-Angle Shower Surround
- Sky Dome in Shower Area
- Brass Look Bath Fixtures
- Mirrored Medicine Cabinet
- Dual Pedestal Marine Toilet w/Sprayer
- One-Piece Fiberglass Tub



P.O. Box 1005 • Nappanee, IN 46550
 Ph. 1-800-289-8787, ext. 3288
 Visit our Web Site at:
www.GULFSTREAMCOACH.com

For further information and available floorplan options, contact your local dealer or Gulf Stream Coach, Inc. Gulf Stream Coach, Inc. reserves the right to make changes in prices, colors, materials, components and specifications and to discontinue models at any time without notice or obligation. Gulf Stream Coach, Inc. assumes no responsibility for any error in type or print reproduction of specifications or floorplans in this brochure. TP 20M 11/97