

Vista CRUISER



**Multi-Year
Quality Circle
Award Winner**

Advanced Ultra-Light Weight Construction

North America's most advanced lightweight travel trailer, featuring innovative floor plans, Azdel synthetic substrate, premium features, European-inspired curved walls and an aerodynamic one-piece laminated fiberglass roof.

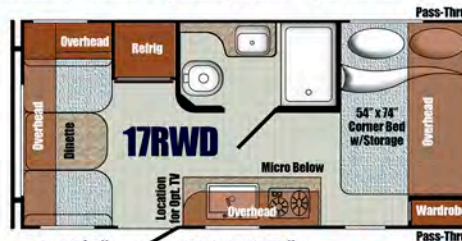

L: 20'0" Wgt: 2,567 lbs.



L: 20'0" Wgt: 2,780 lbs.

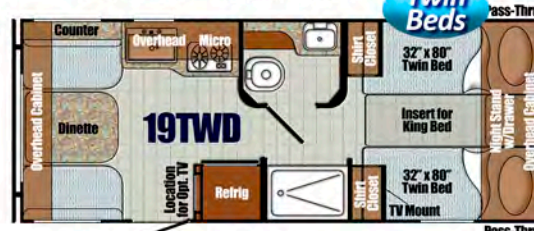

L: 23'1" Wgt: 3,035 lbs.

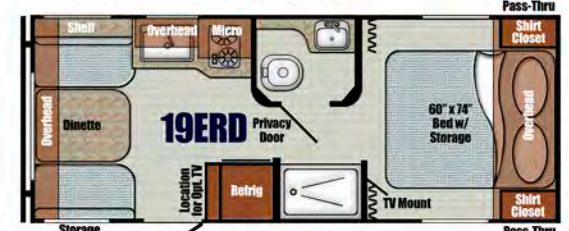

L: 23'1" Wgt: 3,090 lbs.

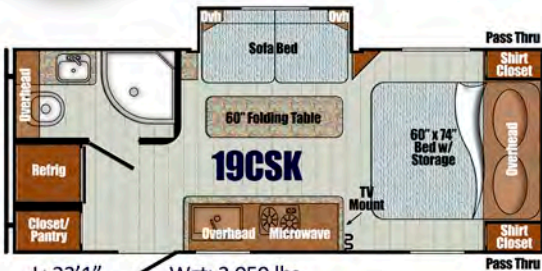

L: 23'1" Wgt: 3,059 lbs.

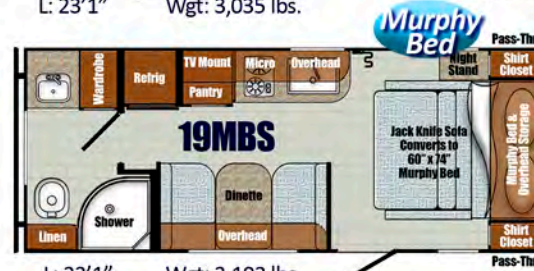

L: 23'1" Wgt: 3,192 lbs.

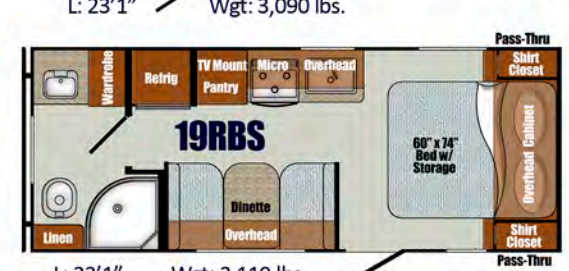

L: 23'1" Wgt: 3,119 lbs.

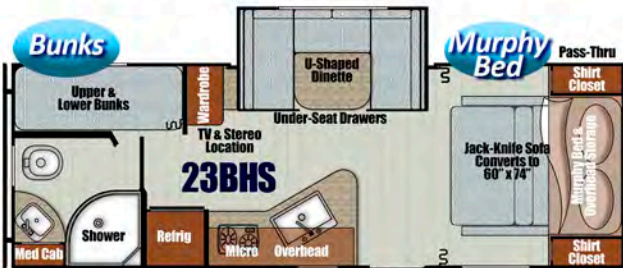

L: 26'1" Wgt: 4,253 lbs.

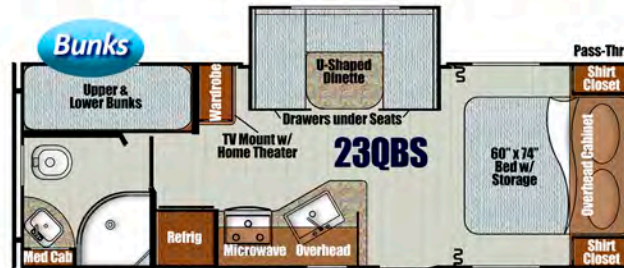

L: 26'1" Wgt: 4,038 lbs.

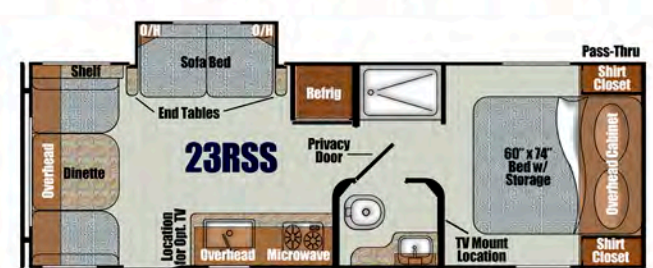

L: 26'1" Wgt: 3,920 lbs.

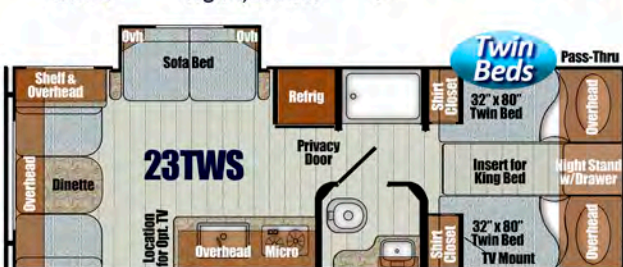

L: 26'1" Wgt: 3,835 lbs.



L: 26'1" Wgt: 4,218 lbs.

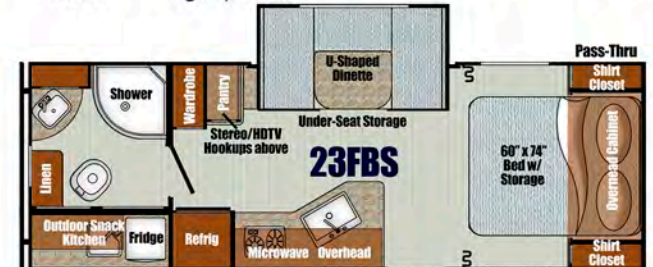

L: 26'1" Wgt: 4,081 lbs.

VISTA CRUISER STANDARDS

EXTERIOR & CONSTRUCTION

- One Piece Fiberglass Roof, Front/Rear Walls
- Tandem Leaf Spring Axles w/Equa-Flex (23' Models)
- Single Axle w/Electric Brakes (17' & 19' Models)
- Easy-Lube Axles
- Laminated Floor w/Lightweight Substrates
- Vacuum-Bonded Laminated Composite Sidewalls w/Azdel Synthetic Substrate
- Lightweight Powder-Coated Steel Chassis
- 14" Radial Tires w/Aluminum Rims
- (2) 20 lbs. LP Bottles w/EZ-Access Cover
- LED Running Lights
- In-Floor Storage Pan Under Bed for Spare Tire
- Four Lightweight Stabilizer Jacks
- Entry Door w/Deadbolt Lock & Friction Hinge
- Black Radius Tinted Safety Windows
- Exterior Pass-Thru Storage w/LED Light & Switch
- Radius Compartment Doors w/Slam Latches & Magnetic Catches
- Diamond Plate lower panel w/LED Lights

HEATING & COOLING

- Prewired for Roof A/C
- 20,000 BTU Gas Furnace w/Wall Thermostat (16,000 BTU on 17RWD, 17SCD, 19CSK)
- 6 Gal Gas DSI Water Heater

MISCELLANEOUS

- Safety Chains, Break-Away Switch
- E-Z Escape Window
- Wall Mount Fire Extinguisher
- Combo LP/CO Detector, Smoke Detector

POWER

- 30 Amp 30' Marincor Power Cord w/Storage
- 55 Amp Converter w/Charger & LED Indicators

INTERIOR

- Solid Surface Galley Countertop
- LED Interior Light Fixtures
- High-Performance Laminated Countertops with continuous molding edge
- Hardwood Cabinet Doors/Drawers w/pocket-screwed construction & solid wood Stiles
- Designer Window Treatments and Night Shades
- Underbed Storage w/Lift Assist
- Advanced Anti-Stick Vinyl Flooring

BATH

- Toilet w/Foot Flush
- High Velocity Bath Vent
- Deluxe Wood Medicine Cabinet w/Mirror
- Radius Shower Curtain
- Tub/Shower Surround
- 24" x 36" Shower (17RWD, 19ERD, 19TWD, 23TWS, 23RSS)
- 32" Radial Shower (17SCD, 19CSK, 19MBS, 19RBS, 23BHS, 23QBS, 23MBS, 23FBS)

KITCHEN

- Stainless Steel 3-Burner Range w/Oven & Glass Cover (2-Burner Cooktop in 17SCD)
- 2 or 3 Drawers w/Dual Ball-Bearing Metal Glides
- 6.0 cu. ft. Two-Door Refrigerator/Freezer (5.0 Single-Door in 17RWD, 17SCD)
- Stainless Steel Power Range Hood w/Light
- Stainless Steel Microwave Oven
- Designer Stainless Hi-Access Faucet & Handles

ELECTRICAL

- Convenience Control Panel w/Tank Monitor
- LED Pass-Thru Storage Light w/Switch
- Non-Directional TV Antenna w/Power Booster
- Satellite/Cable Hookups
- Solar-Ready Access Plug
- Back-Up Camera Ready
- Multiple USB Charging Ports

POPULAR OPTIONS

- Electric Awning w/LED Lighting & Exterior Wall Speakers (required)
- Bumper-Mount Gas Grill w/LP Quick Connect
- Interior & Exterior TV Mounting Brackets
- 19" LED/HDTV
- 13,500 BTU Air Conditioner (non-ducted)
- Power Tongue Jack
- 3-Burner Range w/Oven
- Sink Covers
- 2-Burner Cooktop Cover (17SCD only)
- Home Theater Stereo w/Bluetooth & Speakers
- 14" Spare Tire
- Outside Spray Port
- Premium Foam Mattress
- Microwave Oven
- Glass Shower Door (19MBS, 19RBS, 19CSK, 23BHS, 23QBS, 23MBS, 23FBS)
- Soft Shower Door (17RWD, 19TWD, 19ERD, 23RSS, 23TWS)
- Black Tank Flush
- 6 gal DSI Gas/Electric Water Heater
- Double Solid Safety Step

36 MONTHS OF PROTECTION

In addition to a standard one-year warranty, our exclusive Gulf Stream Coach Structural Warranty gives you DOUBLE the protection with THREE YEARS of coverage on key structural components of your new Vista Cruiser. That extended protection is also offered to Gulf Stream owners by many of the manufacturers that supply components for Vista Cruiser units, including the refrigerator, antenna, furnace, water heater, air conditioner, awning, range, microwave and more. See the official Warranty for details and restrictions.



SPECIFICATIONS

Specifications shown are approximate and subject to change. Check the sticker in your unit for actual weights.

Model	17RWD	17SCD	19TWD	19ERD	19CSK	19MBS	19RBS	23BHS	23QBS	23RSS	23TWS	23MBS	23FBS
Length	20'0"	20'0"	23'1"	23'1"	23'1"	23'1"	23'1"	26'1"	26'1"	26'1"	26'1"	26'1"	26'1"
Height w/AC	10'2"	10'2"	10'2"	10'2"	10'2"	10'2"	10'2"	10'6"	10'6"	10'6"	10'6"	10'6"	10'6"
Width	7'6"	7'6"	7'6"	7'6"	7'6"	7'6"	7'6"	7'6"	7'6"	7'6"	7'6"	7'6"	7'6"
Int. Height	83"	83"	83"	83"	83"	83"	83"	83"	83"	83"	83"	83"	83"
Dry Weight	2,567	2,780	3,035	3,090	3,059	3,192	3,119	4,253	4,038	3,920	3,835	4,218	4,081
Hitch Weight	240	300	380	370	325	420	390	480	440	420	440	600	520
Carrying Cap.	1,413	1,509	1,345	1,294	976	1,228	1,261	1,827	2,002	2,140	2,205	1,982	2,039
Fresh Water	27 gal	27 gal	27 gal	27 gal	27 gal	27 gal	27 gal	27 gal	27 gal	27 gal	27 gal	27 gal	27 gal
Grey Tank	33 gal	33 gal	33 gal	33 gal	33 gal	33 gal	33 gal	33 gal	33 gal	33 gal	33 gal	33 gal	33 gal
Black Tank	33 gal	33 gal	33 gal	33 gal	33 gal	33 gal	33 gal	33 gal	33 gal	33 gal	33 gal	33 gal	33 gal
Hot Water Htr	6 gal	6 gal	6 gal	6 gal	6 gal	6 gal	6 gal	6 gal	6 gal	6 gal	6 gal	6 gal	6 gal
LP Capacity	40 lbs	40 lbs	40 lbs	40 lbs	40 lbs	40 lbs	40 lbs	40 lbs	40 lbs	40 lbs	40 lbs	40 lbs	40 lbs

AZDEL

ONBOARD

AZDEL is a synthetic barrier panel that separates exterior fiberglass from interior space. AZDEL can't absorb moisture; won't mildew or delaminate like wood.



QUALITY • VALUE • INNOVATION

www.gulfstreamcoach.com
503 South Oakland Avenue, Nappanee IN 46550



Scan for more images, videos, and specifications

vista
cruiser
BY GULF STREAM

Your Vista Cruiser Dealer: