

# LUXURY SERIES

TRAVEL TRAILERS  
OF EXTRAORDINARY  
STYLE AND  
LUXURY



## SPECIFICATIONS

Specifications are approximate and subject to change. Check the weight sticker in your unit for actual weights.

	220RB	246BH	258RB	282BH	284QB	290RL
Length	27'11"	30'4"	31'5"	32'0"	34'9"	34'4"
Width	96"	96"	96"	96"	96"	96"
Ext. Height	11'0"	11'0"	11'0"	11'0"	11'0"	11'6"
Int. Height	80"	80"	80"	80"	80"	80"
Dry Weight	5,685	5,903	5,957	6,251	6,737	7,117
Hitch Weight	620	610	740	780	980	920
Net Carry Cap.	1,935	1,707	2,042	1,657	1,262	2,603
Fresh Water	45	45	45	45	45	45
Grey Tank	72	72	72	72	72	36
Black Tank	36	36	36	36	36	36
Furnace	35,000	35,000	35,000	35,000	35,000	35,000
Water Htr.	Tankless	Tankless	Tankless	Tankless	Tankless	Tankless
LP Tank	2 X 20	2 X 20	2 X 20	2 X 20	2 X 20	2 X 20

## LUXURY SERIES FLOOR PLANS

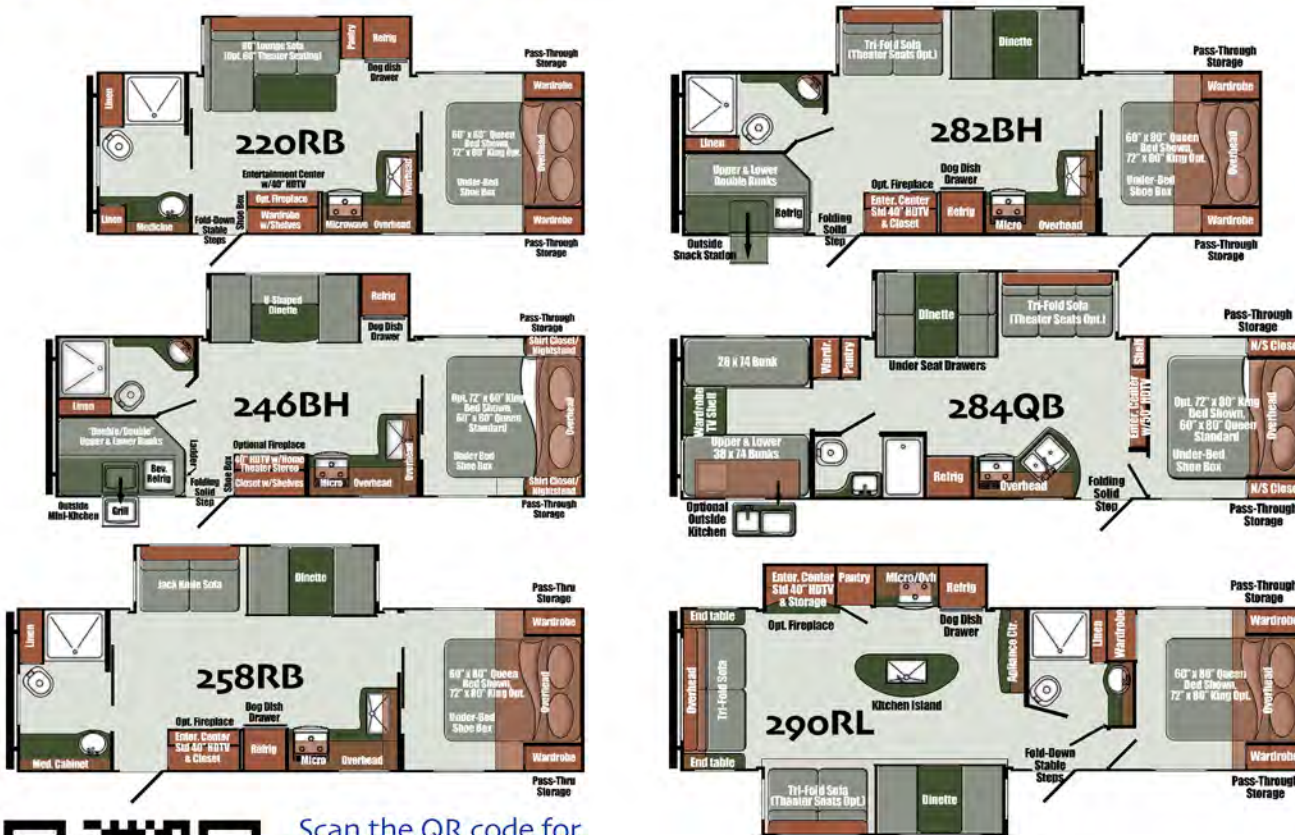

Scan the QR code for more images, videos, and specifications

## BUILD TECH LAMINATED SIDEWALLS

Using processes perfected through years of innovation, our laminated sidewalls combine a light yet resilient welded square-tube aluminum frame and exterior fiberglass with structural, insulating, and decorative layers using advanced heat-resistant adhesives in a vacuum chamber where the layers are bonded into a remarkably light, incredibly strong unit.

- 1 Gleaming exterior fiberglass
- 2 AZDEL synthetic composite
- 3 Rigid closed-cell foam insulation
- 4 Welded square-tube aluminum skeleton frame
- 5 Structural plywood inner wall
- 6 Decorative easy-care vinyl wallcovering

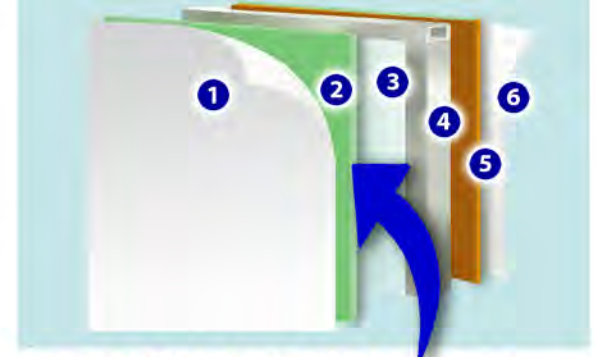

## THE AZDEL ADVANTAGE

Key to LUXURY SERIES vacuum-bonded sidewalls is a structural layer of AZDEL synthetic composite. AZDEL can't absorb moisture, so it won't rot or mildew, and can't delaminate. It insulates against extremes of temperature and noise, contains no formaldehyde, and weighs half as much as the wood it replaces.

# LUXURY SERIES

## STANDARD FEATURES

### Interior

- 'Shrine' Interior w/Muslin Oka Ceiling, Alium Silk Wall Vinyl
- 'Waterville' Wood Finish
- 'Summit Meadow Beige' Vinyl Flooring
- Cabinetry w/Solid Wood Stiles & Cabinet Doors
- Designer Window Treatments

### Heating, Cooling, Electrical

- Pre-wired for Roof Air Conditioner
- Cool, efficient Interior LED Lighting
- LED Motion Sensor Lighting in Pass-Through
- Central Command Switch Panel w/Monitor
- Multiple USB Charging Ports
- LED Motion Sensor Entry Light
- Tech-Ready Features:
  - Wi-Fi Ready
  - Cable and Satellite Connections
  - Solar Panel Ready
  - Back-Up Camera Prep
- Dump Valve Light

### Power

- 35-Amp Converter w/Charger & LED Indicators
- 30 ft. Detachable 30 Amp Power Cord

### Safety

- Safety Chains
- Break-Away Switch
- Wall Mount Fire Extinguisher
- Combo LP and CO Detector
- Smoke Detector
- Exterior LP Gas Hookup

### Bath

- Foot Flush Toilet
- Vortex Bath Fan
- Medicine Cabinet with Mirror
- 30" x 36" Walk-In Shower w/Door & Surround (220RB, 246BH, 258RB, 282BH, 290RL)
- 24" x 26" Bathtub with Surround and Tub/Shower Doors (284QB)
- Skylight in Bath

### Appliances

- Stainless Steel 3-Burner Range w/Oven & Glass Cover
- Stainless Steel Microwave Oven
- Stainless Steel Power Range Hood w/Light
- 12V 10.7 cu. ft. Everchill Refrigerator/Freezer

### Windows and Doors

- Friction Hinge Entry Door(s)
- Black Radius Tinted Windows
- Radius Compartment Doors with Magnetic Latches

### Furnishings

- Designer Window Treatments
- Booth Dinette (258RB, 282BH, 284QB, 290RL)
- U-Shaped Dinette (246BH)
- Tri-Fold Sofa (258RB, 282BH, 284QB, 290RL)
- L-Shaped Lounge w/Folding Table (220RB)
- Bunk Beds w/Poly Mattresses
  - 46" x 73" in 246BH, 282BH
  - 28" x 74" & 38" x 74" in 284QB
- Kid's Dinette/Game Table (284QB)
- 60" x 80" Queen Bed
- Designer Bedspread
- Under-Bed Shoe Storage

### Exterior

- One-Piece Vinyl Roof
- Fiberglass Exterior Sidewalls
- Easy-Lube Axles
- (2) 20 lb. LP Bottles w/Cover
- Gutter Rail & Rain Spouts at Roofline
- Radial Tires w/Aluminum Rims
- Outside Convenience/Snack Center (246BH, 282BH)

## POPULAR OPTIONS

- Free-Standing Table with 4 Chairs
- 2nd Air Conditioner (15,000 BTU)
- 50 Amp Service (required for 2nd A/C)
- Theater Seating in place of Tri-Fold Sofa
- 7 cu. ft. Gas/Electric Refrigerator in place of 12V Everchill
- Painted Front Cap

## INCLUDED LUXURY ITEMS

### Luxury Power Package (Incl., req.)

- Power Tongue Jack
- Power Awning w/LED Lighting
- Electric Stabilizer Jacks
- Heated/Enclosed Underbelly w/Heat Duct
- Thermofoil Wrapped Radius Roof & Flooring
- 35,000 BTU Furnace
- 15,000 BTU Ducted Air Conditioning
- 30 Amp Detachable Power Cord
- Marine Grade Exterior LED Speakers
- Electric Fireplace/Heater
- Blue Tooth Stereo System w/Sound Bar
- 100W Solar Panel w/30 Amp Controller
- LED Exterior Clearance & Tail Lights
- 40" LED TV w/Interior & Exterior Mounting Brackets (Ext. N/A 290RL)

### Worry-Free Camping Package (Incl.)

- Fold-Away Solid Safety-Step
- Fold-Away Safety Grab Handle
- Walk-On Roof w/Ladder
- Exterior Docking Station
- Spare Tire with Carrier
- Fiberglass Front Cap w/LED Lights
- Front Diamond Plate Rock Guard
- Slam-Latch Cargo Doors; Magnetic Catches
- Black Tank Flush
- Tankless Water Heater
- LG Industrial Stainless Steel Kitchen Sink w/Pull-Down Faucet & Cover
- Stainless Steel Appliances
- Easy-Clean Seamless Countertops
- Solid Surface Galley Kitchen Countertop
- Backsplash behind Range

## EMPEROR OPTION

- 72" x 80" King Size Bed for Master Bedroom



## THE LUXURY SERIES 3-YEAR WARRANTY

Our exclusive 3-year Limited Warranty gives you peace of mind by covering key structural components (floor, roof, side, front, and rear walls) of your new LUXURY SERIES travel trailer. In addition, suppliers of other key components also provide enhanced coverage to Gulf Stream Coach customers.

Check the full written warranty for complete information.

For more information visit [www.gulfstreamcoach.com](http://www.gulfstreamcoach.com) or see your Gulf Stream Coach Dealer. Components, features, specifications, and materials are subject to change without further notice. Photos may show optional features. Not responsible for typographical errors.  
© 2023 Gulf Stream Coach, Inc., Nappanee, IN, USA • LUX112023

Your Gulf Stream Coach Dealer:

QUALITY • VALUE • INNOVATION

505 S Oakland Avenue • Nappanee, IN • 46550  
[www.gulfstreamcoach.com](http://www.gulfstreamcoach.com)

