

Vintage CRUISER

The fun of the 50's. the technology of the 21st Century!

Colors, interior design, and graphics of our Vintage Cruisers recall the flat-out fun of the 50's
- But don't worry! State-of-the-art luxuries are here too.

Take your pick! Teal and Cream, Crimson and Cream, or the Knotty Pine "Woodie" option - Any way you go, you'll take the fun of the 50's with you.

19ERD L: 23'1", Wgt: 3,090 lbs.

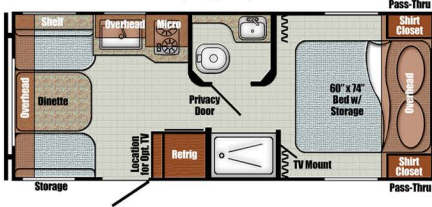

19CSK L: 23'1" Wgt: 3,395 lbs.

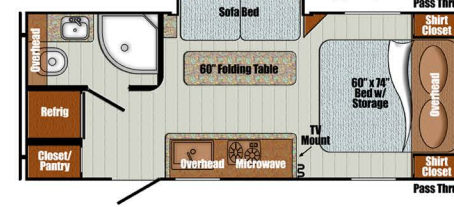

19MBS L: 23'1", Wgt: 3,192 lbs.

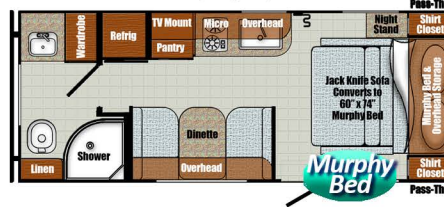

19RBS L: 23'1", Wgt: 3,119 lbs.

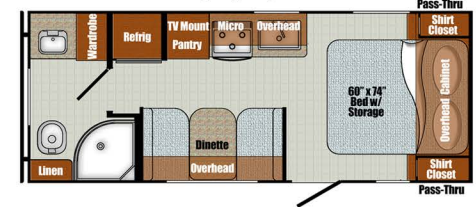

23BHS L: 26'1"

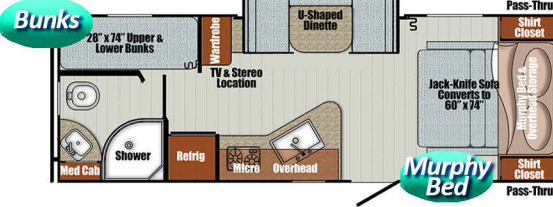

23MBS L: 26'1"

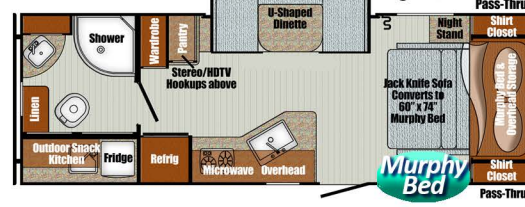

23RSS L: 26'1", Wgt: 3,920 lbs.

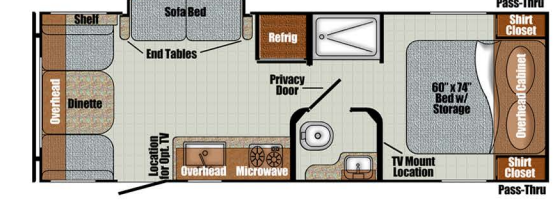

23QBS L: 26'1"

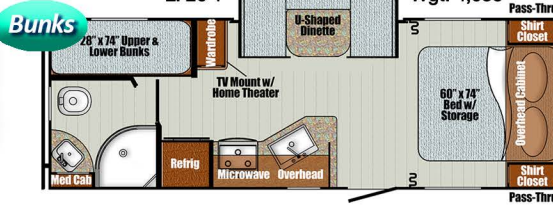

23FBS L: 26'1"

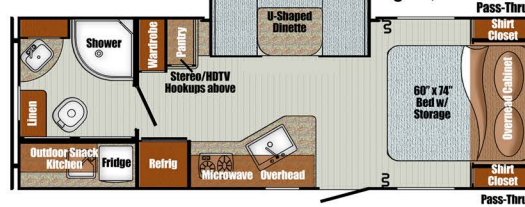

23TWS L: 26'1", Wgt: 3,835 lbs.

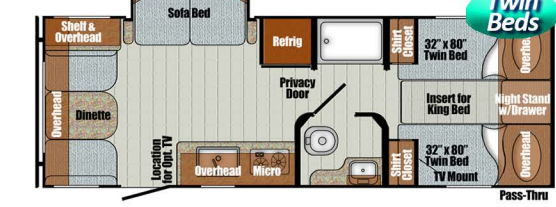

*Multi-Year
Winner. RVDA
Quality Circle
Award!*

Specifications

Specifications are approximate and subject to change. Check Weight Sticker in unit for actual weights.

Model	17RWD	17SCD	19TWD	19ERD	19CSK	19MBS	19RBS	23BHS	23MBS	23RSS	23QBS	23FBS	23TWS
Length	20'0"	20'0"	23'1"	23'1"	23'1"	23'1"	23'1"	26'1"	26'1"	26'1"	26'1"	26'1"	26'1"
Height w/AC	10'2"	10'2"	10'2"	10'2"	10'2"	10'2"	10'2"	10'6"	10'6"	10'6"	10'6"	10'6"	10'6"
Width	7'6"	7'6"	7'6"	7'6"	7'6"	7'6"	7'6"	7'6"	7'6"	7'6"	7'6"	7'6"	7'6"
Interior Height	83"	83"	83"	83"	83"	83"	83"	83"	83"	83"	83"	83"	83"
Dry Weight lbs.	2,567	2,780	3,035	3,090	3,395	3,192	3,119	4,253	4,218	3,920	4,038	4,081	3,835
Hitch Weight lbs.	240	300	380	370	325	420	390	480	600	420	440	520	440
Carrying Cap. lbs.	1,413	1,509	1,345	1,294	976	1,228	1,261	1,827	1,982	2,140	2,002	2,039	2,205
Fresh Water gal.	21	21	21	21	21	21	21	21	21	21	21	21	21
Grey/Black gal.	33/33	33/33	33/33	33/33	33/33	33/33	33/33	33/33	33/33	33/33	33/33	33/33	33/33
Water Heater	Tankless	Tankless	Tankless	Tankless	Tankless	Tankless	Tankless	Tankless	Tankless	Tankless	Tankless	Tankless	Tankless
Furnace (BTU)	19,000	19,000	25,000	25,000	19,000	25,000	25,000	25,000	25,000	25,000	25,000	25,000	25,000
LP Capacity lbs.	2 x 20	2 x 20	2 x 20	2 x 20	2 x 20	2 x 20	2 x 20	2 x 20	2 x 20	2 x 20	2 x 20	2 x 20	2 x 20



**Above: 19ERD Dinette
surrounded by windows;
Teal and Cream interior**



**Below: 19ERD in
Teal and Cream**

Standard Features

Decor

- High-Performance Vinyl Flooring
- Easy-Care Wall & Ceiling Vinyl
- Wood Cabinet Doors, Solid Wood Stiles, Pocket-Screwed Frames
- Tile Backsplash at Range
- Designer Window Treatment

Heating & Cooling, Ventilation

- Prewired for Roof Air Conditioner
- 25,000 BTU Furnace w/Wall Thermostat (19,000 BTU on 17RWD, 17SCD, 19CSK)
- Stainless Power Range Hood w/Light

Safety

- Fold-Away Grab Handle
- Break-Away Switch
- Safety Chains
- Wall-Mount Fire Extinguisher
- Smoke Detector, Combo LP & CO Detector

Electrical/Power

- Satellite & Cable-Ready Prep
- Multiple USB Charging Ports
- Convenience Switch Panel w/Tank Monitor
- LED Pass-Thru Storage Light w/Switch
- LED Interior Ceiling Lights
- Non-Directional TV Antenna w/Booster
- Solar-Ready Prep
- 30 Amp 30' Power Cord w/Storage
- 35 Amp Converter/Charger w/LED Lights

Bath

- Foot Flush Toilet
- High Velocity Bath Vent
- Medicine Cabinet w/Mirror
- Seamless Tub/Shower Surround
- Radius Shower Curtain
- 24" x 36" Shower (17RWD, 19ERD, 19TWD, 23RSS, 23TWS)
- 32" Radial Shower (17SCD, 19RBS, 19MBS, 19CSK, 23BHS, 23QBS, 23MBS, 23FBS)

Furnishing

- U-Dinette (23BHS, 23FBS, 23MBS, 23QBS)
- Booth Dinette (17RWD, 17SCD, 19ERD, 19MBS, 19RBS, 19TWD, 23RSS, 23TWS)
- Sofa Table (19CSK)
- 60" x 74" Bed w/Polyfoam Mattress (19ERD, 19RBS, 19CSK, 23QBS, 23RSS, 23FBS)
- 54" x 74" Corner Bed (17RWD, 17SCD)
- 60" x 74" Murphy Bed w/Sofa (19MBS, 23BHS, 23MBS)
- 32" x 80" Twin Beds w/Insert (19TWD, 23TWS)
- 28" x 74" Bunk Beds (23BHS, 23QBS)
- Spare Tire Storage under Queen & Murphy Beds
- Jack Knife Sofa (19CSK, 23RSS, 23TWS)

Windows & Doors

- Friction Hinge Entry Door
- Black Radius Tinted Safety Windows
- Radius Compartment Doors w/Magnetic Catches

Exterior

- One Piece Fiberglass Roof, Front/Rear Walls
- Light Weight Six-Sided Welded Aluminum Frame, Vacuum Bonded Sidewalls
- Laminated Floor w/Lauan Substrate
- Laminated Fiberglass Sidewalls w/layer of Composite Substrate
- Easy-Lube Axles
- Tandem Leaf Spring Axles w/Equa-Flex (23 ft models)
- Hitch Light
- LED Running Lights
- (2) 20-lb. LP Tanks with Cover
- 14" Radial Tires w/Aluminum Rims
- In-Floor Storage Pan under Bed for Spare Tire

Vintage Package You get all this! (Included, required)

- Vintage Exterior Graphics
- Vintage Painted Bumper, A-Frame & Radius Metal, Fender Skirts, & Rims
- Front & Rear Diamond Plate
- Electric Awning w/LED Lighting
- Exterior Wall Speakers
- Power Tongue Jack
- Radial Tires w/Moon Hub Caps
- Goodyear Endurance Tires w/Spare
- Double Solid Safety Step
- Outside Spray Port
- Black Tank Flush
- 15,000 BTU Non-Ducted Air Conditioner
- Tankless Water Heater
- 3-Burner Range w/Oven (N/A 17SCD)
- 8 cu. ft. 12V Refrigerator

Vintage CRUISER

"Woody" Package Option

We've captured the nostalgic look of a rustic cabin in our "Woody" package with:

- Oyster Painted A-Frame, Bumper, Wheels
- Woody Fender Skirts and Graphics
- Hickory Saddle Floor Vinyl
- Southern Pine Walls, Cabinets & Cabinet Doors

Popular Options

- Rear Bumper Mount Gas Grill
- 7 cu. ft. Gas/Electric Refrigerator in place of 8 cu. ft. 12V Refrig.
- Glass Shower Door (19RBS, 19MBS, 19CSK, 23BHS, 23QBS, 23MBS, 23FBS)
- Soft Shower Door (17RWD, 19ERD, 19TWD, 23RSS, 23QBS, 23MBS; N/A 17SCD)



Meet "The Vintage Cruisers"

You'll find this friendly, helpful, active group of over 5,000 Vintage Cruiser owners on Facebook. Just search Facebook for "The Vintage Cruisers." Better yet, choose a Vintage Cruiser of your own and join in the fun!

Scan the QR code for more images, videos, and specifications



Your Gulf Stream Coach Dealer:



QUALITY • INNOVATION • VALUE

Specifications, materials, & standard features are subject to change without further notice. Not responsible for typographical errors. Some items shown are extra cost options. Visit www.gulfstreamcoach.com or check with a local dealer for more info. ©2024 Gulf Stream Coach, Nappanee, IN USA • #VIN022024

www.gulfstreamcoach.com

503 South Oakland Avenue
Nappanee, IN 46550